



Office of General Services

DESIGN & CONSTRUCTION GROUP
THE GOVERNOR NELSON A. ROCKEFELLER
EMPIRE STATE PLAZA
ALBANY, NY 12242

ADDENDUM NO. 1 TO PROJECT NO. 47655

CONSTRUCTION WORK REPLACE WATER & SEPTIC SYSTEM DOT REGION 9, CHENANGO COUNTY ROUTE 206 BAINBRIDGE, NY

May 22, 2026

NOTE: This Addendum forms a part of the Contract Documents. Insert it in the Project Manual. Acknowledge receipt of this Addendum in the space provided on the Bid Form.

BIDDING REQUIREMENTS

1. DOCUMENT 003132 GEOTECHNICAL DATA: Add the accompanying Section (page 003132-1) to the Project Manual.

SPECIFICATIONS

2. SECTION 028003 DISPOSAL OF NON-HAZARDOUS INDUSTRIAL-COMMERCIAL WASTE: Discard the Section bound in the Project Manual and substitute the Section (pages 028003-1 thru 028003-2) noted "REVISED 05/20/2026."

APPENDIX

3. GEOTECHNICAL DATA: Add the attached Document (pages 1 thru 9) to the Project Manual.

DRAWINGS

4. Revised Drawings:
 - a. Drawing Nos. C-000, C101, C505, noted Addendum 1 dated 5/20/2026, accompanies this Addendum and supersedes the same numbered previously issued drawings.
5. Reference Drawings:
 - a. Sheet Nos. 1R1/326, 2R1/326, 141R1/326, 148R1/326, 149R1/326, 150R1/326, 151R1/326, 152R1/326, 287R1/326, 289/316, 290/316, 291/316, 292R1/326, 295R1/326, 297R1/326, 299R1/326, 302R1/326, 311R1/326, 312R1/326, 313R1/326, noted F.I.S.H 73-4, accompanies this addendum and are included for reference only.

END OF ADDENDUM

Brady M. Sherlock, P.E.
Director, Division of Design
Design & Construction

DOCUMENT 003132

GEOTECHNICAL DATA

The subsurface logs included in this Project Manual were made on the dates indicated on the individual logs. Refer to Figure 1 and logs in the Appendices.

The observed water levels and/or conditions noted on the subsurface logs are as recorded at the time of exploration. These water levels and/or conditions may vary considerably with time, according to the prevailing climate, rainfall, or other factors and are otherwise dependent on the duration of and method used in the explorations program.

Sound engineering judgment was exercised in preparing the subsurface logs. This information was prepared and is intended for State design and estimate purposes only. Its presentation is for the purpose of providing intended users with access to the same information available to the State. These subsurface logs are presented in good faith and are not intended as a substitute for personal investigation, independent interpretations, or judgment of the bidders.

On July 16, 2024, LaBella Associates performed deep test and percolation testing in the proposed septic system replacement area.

On July 16, 2024, LaBella Associates performed deep test and percolation testing in the proposed septic system replacement area.

Deep Test DT #1
10" Topsoil
10"-24" Sandy Loam
24"-3' Sandy Loam, trace clay, mineral deposits at 30"
3'-4' Clay

Deep Test DT #2
10" Topsoil
10"-30" Sandy Loam
30" Mineral Deposits
30"-4' Clay

The percolation tests results were as follows:

PH #1: 12 mpi @ 12"
PH#2: 18 mpi@ 18"
PH#3: 21 mpi@20"

On September 4, 2024, LaBella Environmental, LLC performed soil boring at six locations along State Route 206. Boring logs are on the following page.

END OF DOCUMENT

SECTION 028003 - DISPOSAL OF NON-HAZARDOUS INDUSTRIAL-COMMERCIAL WASTE

PART 1 - GENERAL

1.1 REFERENCES

- A. 6 NYCRR - New York State Codes, Rules, and Regulations.

1.2 DESCRIPTION

- A. Pump out the existing septic tanks, remove, and dispose of at an approved facility. Pump out, hauling, and disposal to be conducted by a qualified licensed sanitary waste disposal Company. The Work of this Contract includes the removal, transporting and disposal of this material as an industrial/commercial waste.

1.3 SUBMITTALS

- A. Quality Control Submittals:

1. Detailed list of the codes, rules and regulations which are understood to govern the Work. This list must cite specific title, chapter, and section of the citation.
2. Listing of licenses or permits issued by government agencies authorizing the handling of the waste by the qualified Company, transporter, and operator of the disposal facility.
3. Detailed step by step procedure indicating how the Work is to be accomplished. Procedure shall also include information for off-site Work, such as:
 - a. Method of disposal.
 - b. Owner and operator of the disposal facility.
 - c. Location of the disposal facility.
 - d. Method of transporting to the disposal facility.
4. Qualified Company Data:
 - a. Name, address, and telephone number.
 - b. Brochure explaining services offered.
 - c. Experience directly applicable to the required services.
 - d. Type and listing of equipment proposed to be used for the Work.

- B. Submittals for this section are subject to the re-evaluation fee identified in Article 4 of the General Conditions.

- C. Manufacturer's installation instructions shall be provided along with product data.

- D. Submittals shall be provided individually in the order in which they are specified and tabbed.

1.4 QUALITY ASSURANCE

- A. Qualified Company: The Work shall be performed by a qualified Company having at least 3 years experience directly applicable to the services required.
- B. Pre-Work Conference: Before the Work of this Section is scheduled to commence, a conference will be held by the Director's Representative at the Site for the purpose of reviewing the Contract Documents, discussing requirements for the Work, and reviewing the Work procedures.

1.5 PROJECT CONDITIONS

- A. Environmental Requirements:
 - 1. Comply with all applicable governmental agency codes, rules, and regulations for handling non-hazardous industrial, commercial and non-industrial waste.

PART 2 - PRODUCTS

2.1 MATERIALS FOR USE DURING DISPOSAL PROCEDURE

- A. Furnish materials which meet all applicable governmental agency codes, rules and regulations.

PART 3 - EXECUTION

3.1 PERFORMANCE

- A. Remove, and dispose of the materials in accordance with all applicable governmental agency codes, rules, and regulations.

END OF SECTION 028003

GEOTECHNICAL DATA

The observed water levels and/or conditions noted on the subsurface logs are as recorded at the time of exploration. These water levels and/or conditions may vary considerably with time, according to the prevailing climate, rainfall, or other factors and are otherwise dependent on the duration of and method used in the explorations program.

Sound engineering judgment was exercised in preparing the subsurface logs. This information was prepared and is intended for State design and estimate purposes only. Its presentation is for the purpose of providing intended users with access to the same information available to the State. These subsurface logs are presented in good faith and are not intended as a substitute for personal investigation, independent interpretations, or judgment of the bidders.

On July 16, 2024, LaBella Associates performed deep test and percolation testing in the proposed septic system replacement area.

Deep Test DT #1
10" Topsoil
10"-24" Sandy Loam
24"-3' Sandy Loam, trace clay, mineral deposits at 30"
3'-4' Clay

Deep Test DT #2
10" Topsoil
10"-30" Sandy Loam
30" Mineral Deposits
30"-4' Clay

The percolation tests results were as follows:
PH #1: 12 mpi @ 12"
PH#2: 18 mpi@ 18"
PH#3: 21 mpi@20"

On September 4, 2024, LaBella Environmental, LLC performed soil boring at six locations along State Route 206. Boring logs are on the following page.

END OF DOCUMENT

REPLACE WATER & SEPTIC SYSTEM

NYS DOT REGION 9, CHENANGO COUNTY ROUTE 206 BAINBRIDGE, NY PROJECT 47655-C

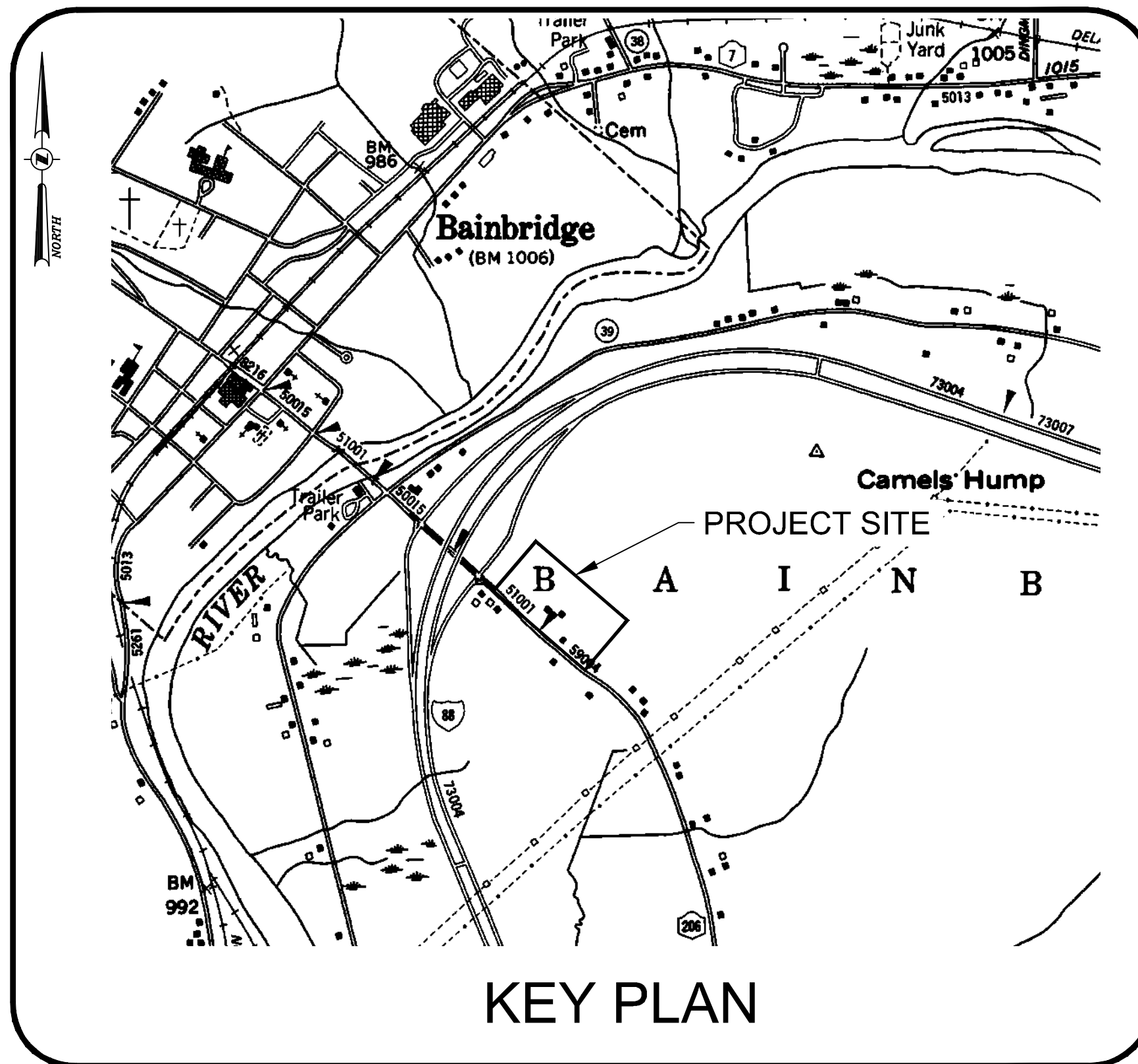

INDEX OF DRAWINGS

C-000	COVER SHEET
C-001	GENERAL NOTES AND LEGENDS
C-101	EXISTING CONDITIONS AND REMOVAL PLAN
C-301	UTILITY PLAN
C-302	UTILITY PLAN
C-401	GRADING AND EROSION CONTROL PLAN
C-402	WATERMAIN AND WATER SERVICE PROFILES
C-501	SEPTIC SYSTEM DETAILS
C-502	SEPTIC SYSTEM DETAILS
C-503	SEPTIC SYSTEM DETAILS
C-504	WATER SYSTEM DETAILS
C-505	SITE DETAILS
C-506	NYSDOT DETAILS
C-507	NYSDOT DETAILS
C-508	NYSDOT DETAILS
C-509	WORK ZONE TRAFFIC CONTROL PLAN
C-511	MUNICIPAL WATER SERVICE CONNECTION & WELL DECOMMISSIONING DETAILS
C-512	ELECTRICAL SITE PLAN

REFERENCE DRAWINGS:

1/326	RECORD PLAN TITLE SHEET
2/326	RECORD PLAN INDEX SHEET
141/326	50' PLAN
148/326	50' PROFILES
149/326	50' PLAN
150/326	50' PLAN
151/326	NY ROUTE 206 PROFILE
152/326	50' PLAN
287/326	BRIDGE NO. 4 — PLAN, ELEVATION, PROFILES AND SECTIONS
289/326	BRIDGE NO. 4 —GENERAL SUBSURFACE PROFILE FOR
290/326	BRIDGE NO. 4 — PLAN, EXCAVATION AND EMBANKMENT
291/326	BRIDGE NO. 4 — EXCAVATION & EMBANKMENT SECTIONS
292/326	BRIDGE NO. 4 — SOUTH ABUTMENT, WESTBOUND
295/326	BRIDGE NO. 4 — NORTH ABUTMENT, WESTBOUND
297/326	BRIDGE NO. 4 — NORTH ABUTMENT, WESTBOUND
299/326	BRIDGE NO. 4 — SOUTH ABUTMENT, EASTBOUND
302/326	BRIDGE NO. 4 — NORTH ABUTMENT, EASTBOUND
311/326	BRIDGE NO. 4 — DRAINAGE AND GUTTER UTILITY DETAILS
312/326	BRIDGE NO. 4 — DRAINAGE AND GUTTER UTILITY DETAILS
313/326	BRIDGE NO. 4 — LIGHTING / TELEPHONE / UTILITY DETAILS



REVISED DRAWING
05/20/2026

UNIFORM CODE STATEMENT:
TO THE BEST OF THE REGISTERED DESIGN PROFESSIONAL'S KNOWLEDGE, BELIEF AND PROFESSIONAL JUDGEMENT, THESE PLANS AND SPECIFICATIONS ARE IN COMPLIANCE WITH THE 2020 UNIFORM CODE.

ENERGY CODE COMPLIANCE WRITTEN STATEMENT:
TO THE BEST OF THE REGISTERED DESIGN PROFESSIONAL'S KNOWLEDGE, BELIEF AND PROFESSIONAL JUDGEMENT, THESE PLANS AND SPECIFICATIONS ARE IN COMPLIANCE WITH THE 2020 ENERGY CODE.

DRAWING NUMBER:

C-000

SHEET 1 OF 18

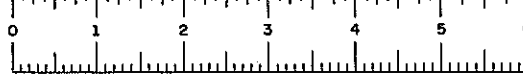

FED. ROAD RES. NO.	STATE	FEDERAL AID PROJECT NO.	SHEET NO.	TOTAL SHEETS
1	N.Y.	I-88-1(28) RS-273(4)	1/1	326 326
INTERSTATE ROUTE 508				
AFTON - BAINBRIDGE				
CHENANGO COUNTY				

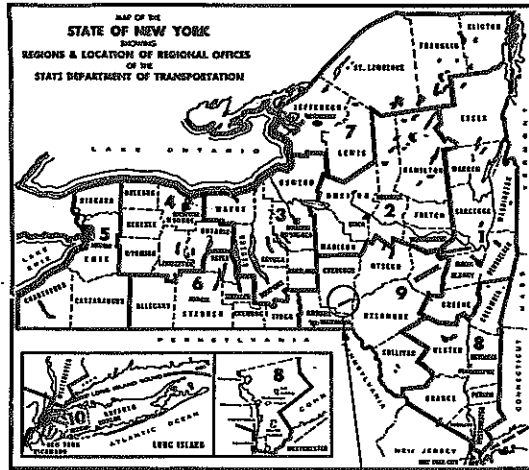

STATE OF NEW YORK
DEPARTMENT OF TRANSPORTATION
DESIGN AND CONSTRUCTION DIVISION

PLANS FOR CONSTRUCTING WITH FEDERAL AID, THE

INTERSTATE ROUTE 508
Afton - Bainbridge

From Station 1246+82 WB to Station 1601+47 WB, a length of 6.55 miles (Plus 4.5 miles of Access), of which 3.13 miles (plus 2.5 miles of Access) is in the Town of Afton and 3.42 miles (Plus 2.0 miles of Access) is in the Town of Bainbridge

326
326 SHEETS

F.A. PROJECT Nos. I-88-1(28)
RS-273(4)

CONTRACT No. FISH 73-4

CHENANGO COUNTY

TYPE OF CONSTRUCTION
 Asphalt Concrete, Type 1A
 Including
 Bridge #1, I-508 over Ellis Hill Road,
 3 Span Comp. Girder, 244' Total Length EB,
 289' Total Length WB
 Bridge #2, I-508 over Bennettville Road,
 Single Span Comp. Girder, 117', Long EB and WB
 Bridge #3, I-508 over Big Brook,
 Triple Concrete Box, 73' Long EB and WB
 Bridge #4, I-508 over Rte. 206,
 Single Span Comp. Girder, 139' Long EB and WB

STANDARD SHEETS
 67-1, 69-4, 72-9HB, 71-14A, 71-14B, 71-15, 67-19,
 68-19A, 68-19B, 69-20, 67-35, 72-43A, 72-43B, 70-43C,
 64-45, 64-45A, 64-45B, 65-45C, 65-52B, 71-53, 67-57,
 58-60, 67-61, 61-62A, 61-62B, 63-62C, 67-64AR1,
 67-64BR1, 67-64C, 67-64D, 67-64E, 68-67R2

All work contemplated under this contract to be covered by and in conformity with the specifications adopted January 2, 1962 as amended by Addenda No. 1 thru No. 51, except as modified on these plans and in the Itemized Proposal.

RECORD PLANS

DESIGN TRAFFIC DATA

DESIGN CLASS - INTERSTATE

EST. 1994 TRAFFIC D.H. 990

DESIGN SPEED 70 AADT 9435

APPROXIMATE LOCATION: THIS PROJECT BEGINS NEAR THE EASTERLY LIMITS OF THE VILLAGE OF AFTON, PROCEEDS NORTH EASTERLY FOR 6.5 MILES ALONG THE SUSQUEHANNA RIVER TO A POINT 1.5 MILES NORTHEAST OF THE EASTERLY LIMITS OF THE VILLAGE OF BAINBRIDGE.

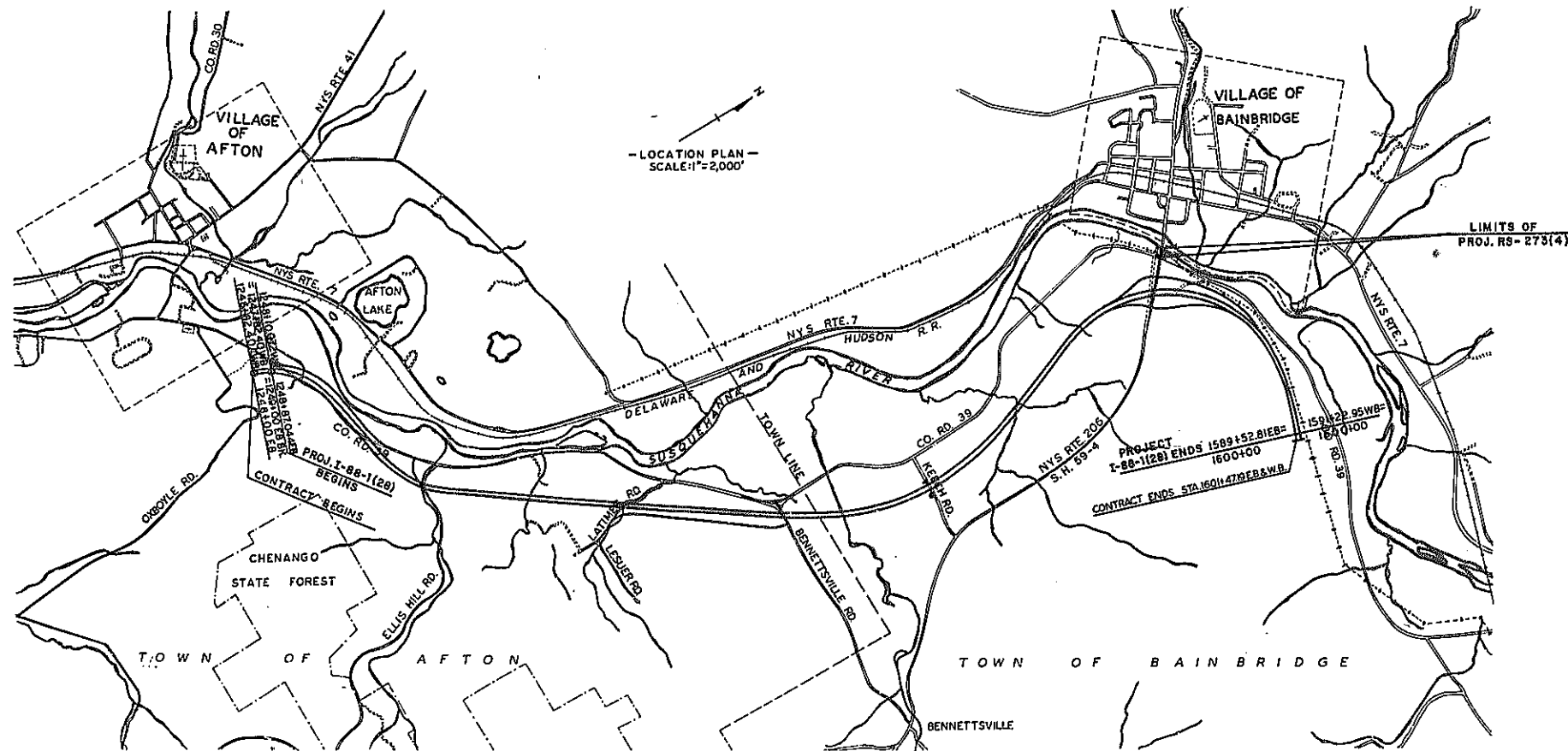

- LOCATION PLAN -
SCALE: 1"=2,000'

RECOMMENDED BY

Francis P. Churchill 9/25/72
REGION 7 DESIGN ENGR. DATE

RECOMMENDED BY

Justin Beach 11/15/72
REGIONAL DESIGN ENGR. DATE

RECOMMENDED BY

Henry Carlson 11/10/72
REGIONAL CONSTRUCTION ENGR. DATE

RECOMMENDED BY

St. Russell 11-15-72
REGIONAL H'WAY MAINT ENGR. DATE

RECOMMENDED BY

[Signature]
REGIONAL TRAFFIC ENGR. DATE

RECOMMENDED BY

[Signature] 10/16/72
REGIONAL DIRECTOR DATE

Capital Project Identification No. 9357.03.

NEW YORK STATE DEPARTMENT OF TRANSPORTATION

Approved: *[Signature]* 10/16/72
JACK STERNBACH Deputy Chief Engineer (Construction)

Approved: *[Signature]* 12/18/72
R. N. KAMP Deputy Chief Engineer (Structures)

Approved: *[Signature]* Dec. 13, 1972
MALCOLM D. GRAHAM Deputy Chief Engineer (Facilities Design)

Approved: *[Signature]* Dec. 20, 1972
GEORGE M. McALPIN Chief Engineer

DEPARTMENT OF TRANSPORTATION
FEDERAL HIGHWAY ADMINISTRATION

APPROVED: _____
DIVISION ENGINEER DATE

**REFERENCE DRAWING
NOT TO SCALE**

DRAFTED BY *[Signature]* 9/25/72 DESIGNED BY *[Signature]* 9/25/72 CHECKED BY *[Signature]* 10/1/72 REVIEWED BY *[Signature]* 10/1/72

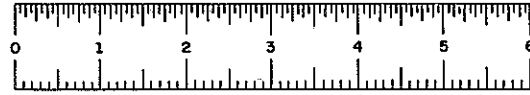

FED. ROAD RES. NO.	STATE	FEDERAL AID PROJECT NO.	SHEET NO.	TOTAL SHEETS
1	N.Y.		281	326
INTERSTATE ROUTE 508				
AFTON - BAINBRIDGE				
CHENANGO COUNTY				

ITEM LEGEND FOR TYPICAL SECTIONS	
ITEM NO.	DESCRIPTION
2A-9	EXCAVATION AND DISPOSAL OF EXCAVATED MATERIAL
2B-9	EMBANKMENT IN PLACE
2EC-B	SELECTED FILL
2EF-B	SELECTED GRANULAR FILL
2SP9	GRANULAR FILL, SLOPE PROTECTION
2UF9	UNDERDRAIN FILTER
3	SUBBASE COURSE - GRANULAR MATERIAL
4	SUBBASE COURSE, SELECT GRANULAR MATERIAL
5B	STRUCTURE EXCAVATION
5T	TRENCH AND CULVERT EXCAVATION
11H6	PERFORATED CORRUGATED METAL PIPE UNDERDRAIN, 6" DIA.
20	CLASS B - CONCRETE FOR STRUCTURES
32DI	CABLE GUIDE RAILING (BEAM POSTS)
33AF	BOX BEAM GUIDE RAIL
45SP	BASE COURSE ASPHALT CONCRETE, TYPE IA
51-F	ASPHALT CONCRETE (TWO COURSE) TYPE IA TOP (HIGH FRICTION) AND BINDER
51FBY	ASPHALT CONCRETE - TYPE IA BINDER VIBRATORY COMPACTION
51FZ	ASPHALT CONCRETE, TYPE IA (TOP COURSE)
51S	COLORED SYNTHETIC BINDER CONCRETE (YELLOW)
51TL	ASPHALT CONCRETE TRUING AND LEVELING COURSE
51Z	ASPHALT CONCRETE, TYPE IA (TOP COURSE)
55S	SURFACE COURSE FOR STABILIZED SHOULDERS (SINGLE SURFACE TREATMENT)
59WABX	BITUMINOUS STABILIZED COURSE (INCLUDING SHOULDERS)
60S	SURFACE TEXTURE AND COLOR CONTRAST COURSE FOR STABILIZED SHOULDERS
64C	SYNTHETIC RESIN BINDER
64CP	PIGMENT FOR COLORED SYNTHETIC BINDER CONCRETE
66G	SYNTHETIC RESIN RAPID CURING CUT-BACK
94BR	STONE CURB (BRIDGE TYPE)
94MR	OPTIONAL CURB
10S	CONCRETE SIDEWALK
123X	SEEDING - MODIFIED
685.02	YELLOW THERMOPLASTIC REFLECTORIZED PAVEMENT MARKINGS

INDEX		
SHEET NO.	DRAWING NO.	DESCRIPTION
1		TITLE SHEET
1R1		RECORD PLAN DATA
2	2	INDEX SHEET AND ITEM LEGEND
3-23	TS-1 TO TS-21	TYPICAL SECTIONS - RELATED DETAILS
24-26	Q1-3	SUMMARY OF QUANTITIES
27	SA-1	TABLE OF ABBREVIATIONS AND SYMBOLS
28-37	MPR1-10	1" = 200' PROFILE
38-44	MPL1-7	1" = 200' PLAN - MAINTENANCE JURISDICTION MAINTENANCE OF TRAFFIC
45	MT-1	SUGGESTED PROCEDURE FOR MAINTAINING TRAFFIC
46-48	MJ1-3	TABLE OF MAINTENANCE JURISDICTION
49-50	BT1-2	BASE LINE TIES
51-52	DT1-2	CONTROL POINT COORDINATES AND TABLE OF BENCH MARKS
53-54	DT3-4	EARTHWORK SUMMARY SHEETS
55-56	DT5-6	DRAINAGE TABLE
57	DT-7	GUIDE RAILING
58	DT-8	LOCATION TABLE FOR MISCELLANEOUS ITEMS
59	DT-9	DISPOSAL OF BUILDINGS AND TABLE OF DRIVEWAYS
60-61	DT10-11	UTILITY DISPOSITION TABLE
62-71	DD1-10	DRAINAGE DETAILS
72-73	SD1-2	SPECIAL SOILS DETAILS
74-78	SD3-7	SPECIAL DETAILS
79-82	RD1-4	ROADSIDE DEVELOPMENT SHEETS
83-91	PD1-9	PLANTING DETAILS
92-95	GPI-4	GRADING PLAN
96-167	PL1-29 & PR1-41	1" = 50' SCALE PLAN AND PROFILE
168-169	STDI-2	SIGN TEXT DATA SHEETS
170-206	S1-37	TRAFFIC SIGNS
207	HB-1	HIGHWAY BARRICADE
208-209	SDSI-2	SPECIAL DETAIL SIGNS
210-211	LDI-2	LIGHTING DETAILS
212-213	UPI-2	PIPESLEEVE LOCATIONS FOR FUTURE UTILITIES
214-219	C1-6	LARGE CULVERT DETAILS AND PLANS
220-227		COMMON DETAILS - BRIDGES
228-260		BRIDGE NO. 1 - ELLIS HILL ROAD
261-279		BRIDGE NO. 2 - BENNETTSVILLE ROAD
280-286		BRIDGE NO. 3 - BENNETTS CREEK
287-316		BRIDGE NO. 4 - ROUTE 206

▲ SHEET ADDED TO INDEX
 ▲ ITEMS ADDED
 ▲ ITEM REVISED
 ▲ ITEMS DELETED

INDEX		
ITEM LEGEND FOR TYPICAL SECTIONS		
DATE	SCALE	DRAWING NUMBER
9/72	NONE	2

IN CHARGE OF _____ DESIGNED BY _____ CHECKED BY _____ REVIEWED BY _____ DATED _____

REFERENCE DRAWING
 NOT TO SCALE

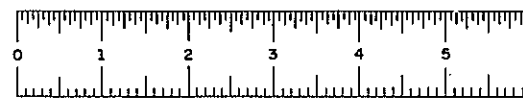

FED. ROAD REG. NO.	STATE	FEDERAL AID PROJECT NO.	SHEET NO.	TOTAL SHEETS
1	N.Y.		1121	326

INTERSTATE ROUTE 508
 AFTON - BAINBRIDGE
 BAINBRIDGE-MASONVILLE P.TS. I&II S.H. 51-2P & 51-1
 CHENANGO COUNTY

BRIDGE NO. 4	
WB 1525+74.88	BR. BEGIN
WB 1527+14.17	BR. END
EB 1525+77.28	BR. BEGIN
EB 1527+14.34	BR. END

- ▲ PLANTING NOTED
- ▲ DRAIN DELETED
- ▲ DRAINAGE REVISED
- ▲ INTERMEDIATE MONUMENT INSTALLED
- ▲ R.O.W. FENCE REVISED
- ▲ NOTE ADDED
- ▲ PERM. SURVEY MARKER INSTALLED
- ▲ GUIDE RAILING REVISED

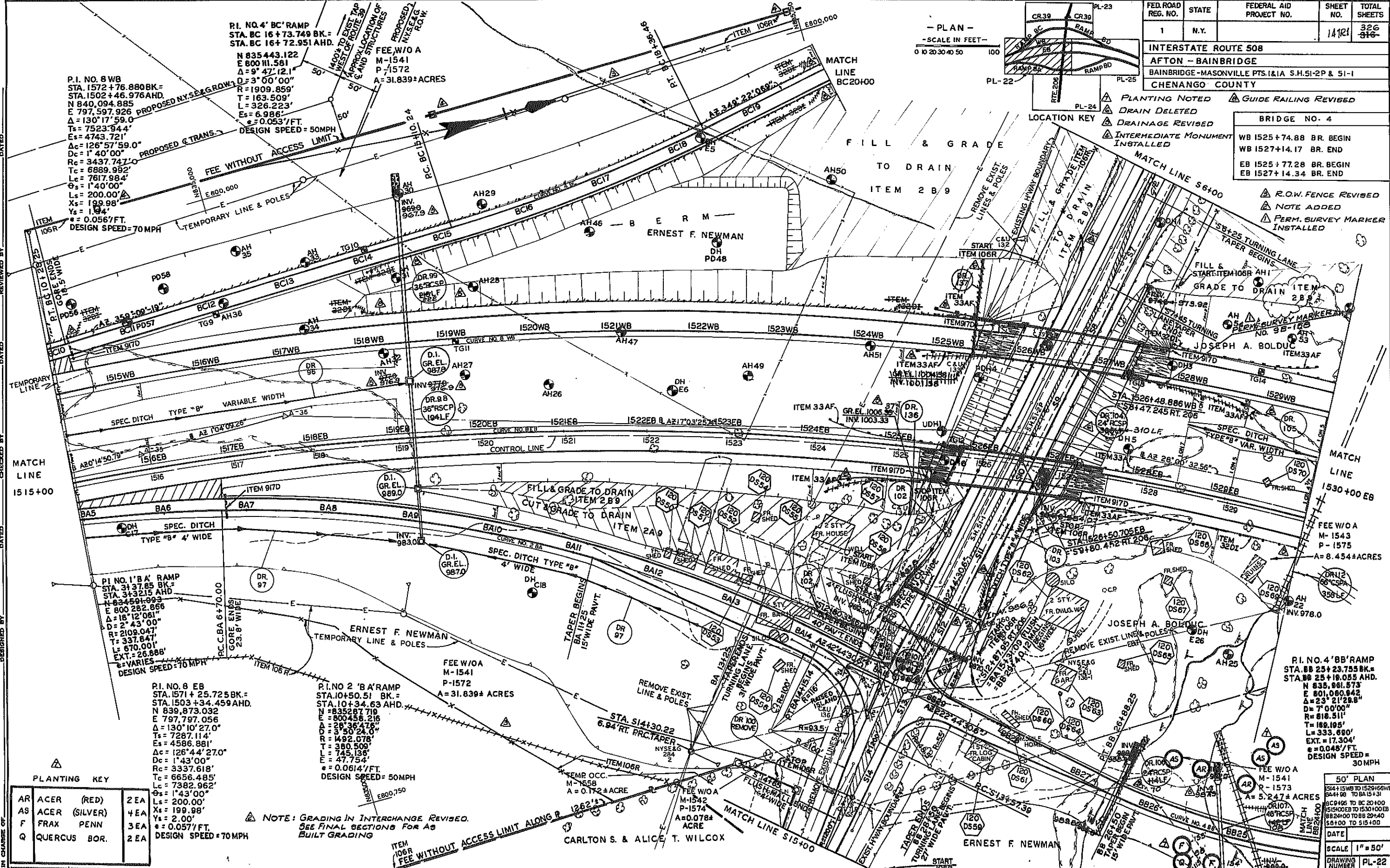

DESIGNED BY: [Name]
 CHECKED BY: [Name]
 DATED: [Date]

P.I. NO. 8 WB
 STA. 1572+76.88 BK.=
 STA. 1502+46.976 AHD.
 N 840,094.885
 E 797,597.926
 $\Delta = 130^\circ 17' 59.0''$
 $T_s = 7523.944'$
 $E_s = 4743.721'$
 $A_c = 126^\circ 57' 59.0''$
 $D_c = 1^\circ 40' 00''$
 $R_c = 3437.747'$
 $T_c = 6889.992'$
 $L_c = 7617.984'$
 $L_s = 200.00'$
 $X_s = 199.98'$
 $Y_s = 1.94'$
 $e = 0.0567/FT.$
 DESIGN SPEED = 70 MPH

P.I. NO. 1 'B' A' RAMP
 STA. 3137.85 BK.=
 STA. 3132.15 AHD.
 N 824,501.093
 E 800,282.866
 $\Delta = 18^\circ 12' 06.1''$
 $D = 2^\circ 43' 00''$
 $R = 2109.047'$
 $T = 337.847'$
 $L = 670.00'$
 $EXT. = 26.886'$
 $e = VARIES$
 DESIGN SPEED = 70 MPH

P.I. NO. 8 EB
 STA. 1571+25.725 BK.=
 STA. 1503+34.459 AHD.
 N 839,873.032
 E 797,797.056
 $\Delta = 130^\circ 10' 27.0''$
 $T_s = 7287.114'$
 $E_s = 4586.881'$
 $A_c = 126^\circ 44' 27.0''$
 $D_c = 1^\circ 43' 00''$
 $R_c = 3337.618'$
 $T_c = 6656.485'$
 $L_c = 7382.962'$
 $L_s = 200.00'$
 $X_s = 199.98'$
 $Y_s = 2.00'$
 $e = 0.0577/FT.$
 DESIGN SPEED = 70 MPH

P.I. NO. 2 'B' A' RAMP
 STA. 10+50.51 BK.=
 STA. 10+34.63 AHD.
 N 835,287.719
 E 800,456.216
 $\Delta = 29^\circ 39' 47.8''$
 $D = 3^\circ 50' 24.0''$
 $R = 1492.078'$
 $T = 380.509'$
 $L = 745.136'$
 $E = 47.754'$
 $e = 0.0614/FT.$
 DESIGN SPEED = 50 MPH

PLANTING KEY

AR	ACER (RED)	2EA
AS	ACER (SILVER)	4EA
F	FRAX PENN	3EA
Q	QUERCUS BOR.	2EA

NOTE: GRADING IN INTERCHANGE REVISED.
 SEE FINAL SECTIONS FOR AS BUILT GRADING

REFERENCE DRAWING
 NOT TO SCALE

50' PLAN

DATE	
SCALE	1" = 50'
DRAWING NUMBER	PL-22

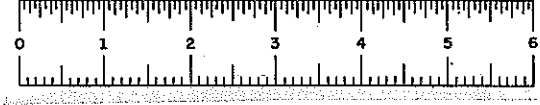

F.I.S.H. 73-4

FED. ROAD REG. NO.	STATE	FEDERAL AID PROJECT NO.	SHEET NO.	TOTAL SHEETS
1	N.Y.		148	226
INTERSTATE ROUTE 508				
AFTON - BAINBRIDGE				
CHENANGO COUNTY				

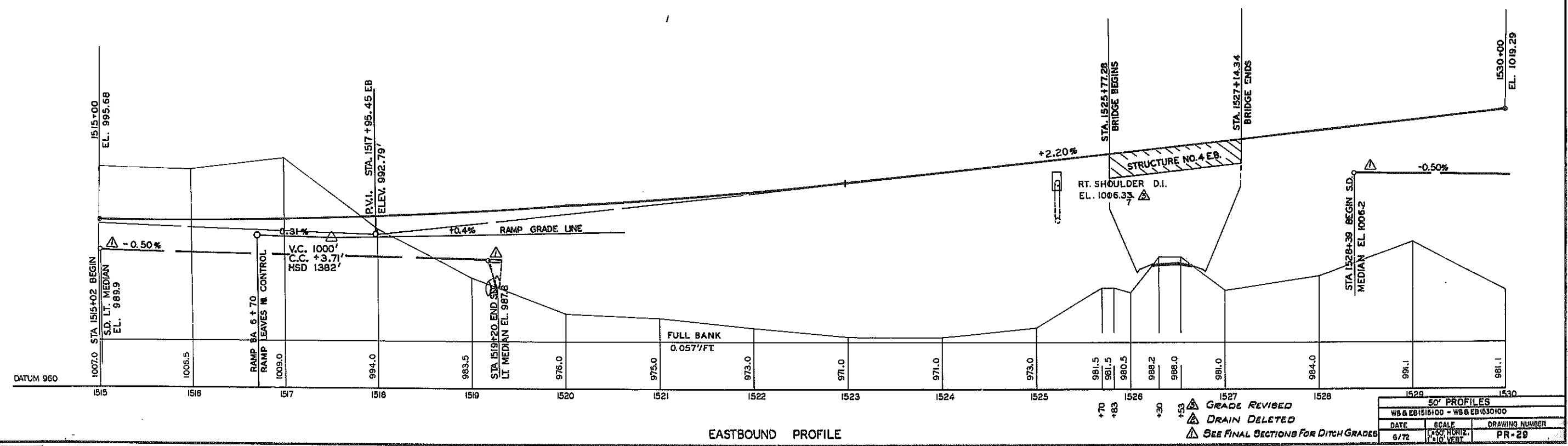
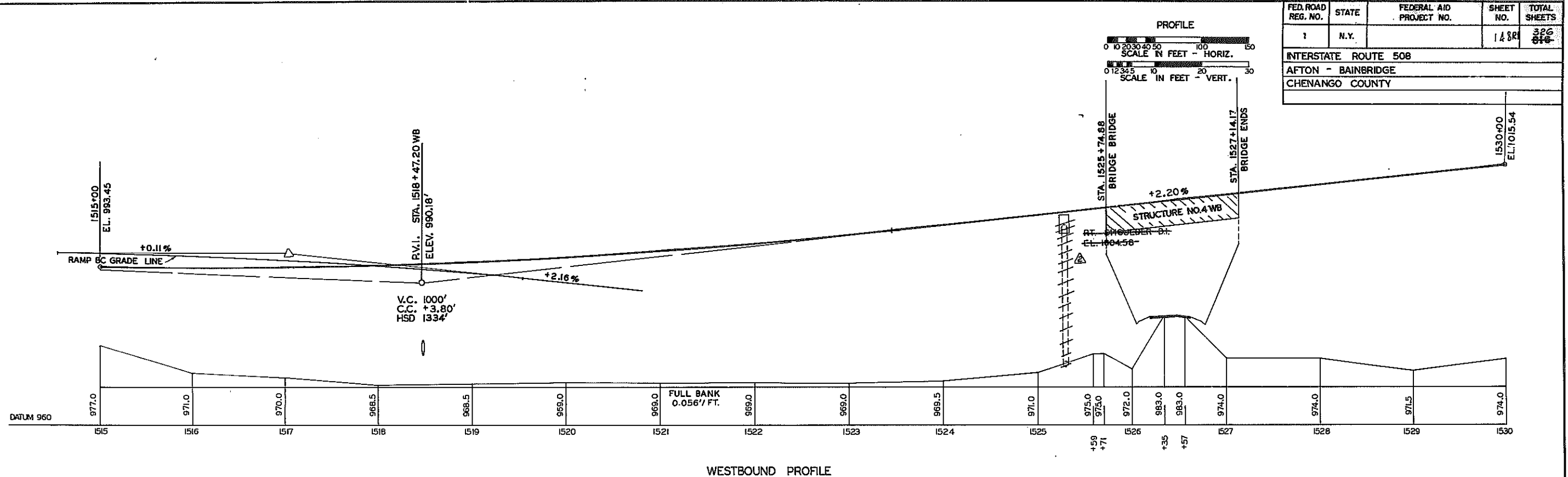

DESIGNED BY D. HEASLEY DATED 1-72 CHECKED BY RAYMOND B. KELLEY DATED 4/5/72 REVIEWED BY _____ DATED _____
 IN CHARGE OF E. CORNISH

50' PROFILES		
WB & EB 1516+00 - WB & EB 1530+00		
DATE	SCALE	DRAWING NUMBER
6/72	1"=100' HORIZ. 1"=10' VERT.	PR-29

REFERENCE DRAWING
 NOT TO SCALE

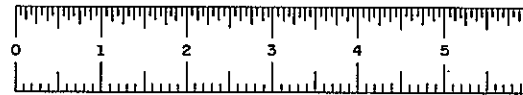

F.I.S.H. 73-4

FED. ROAD REG. NO.	STATE	FEDERAL AID PROJECT NO.	SHEET NO.	TOTAL SHEETS
1	N.Y.		1A-DRI	326-318
INTERSTATE ROUTE 508				
AFTON-BAINBRIDGE				
BAINBRIDGE-MASONVILLE PTS. 1&1A S.H. 51-2P & 51-1				
CHENANGO COUNTY				

- PLAN -
- SCALE IN FEET -
0 10 20 30 40 50 100

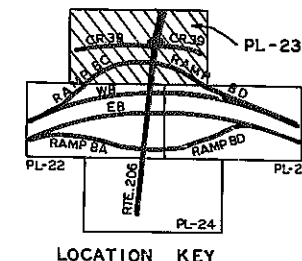

Note: GRADING IN INTERCHANGE AREA REVISED. See FINAL SECTIONS.

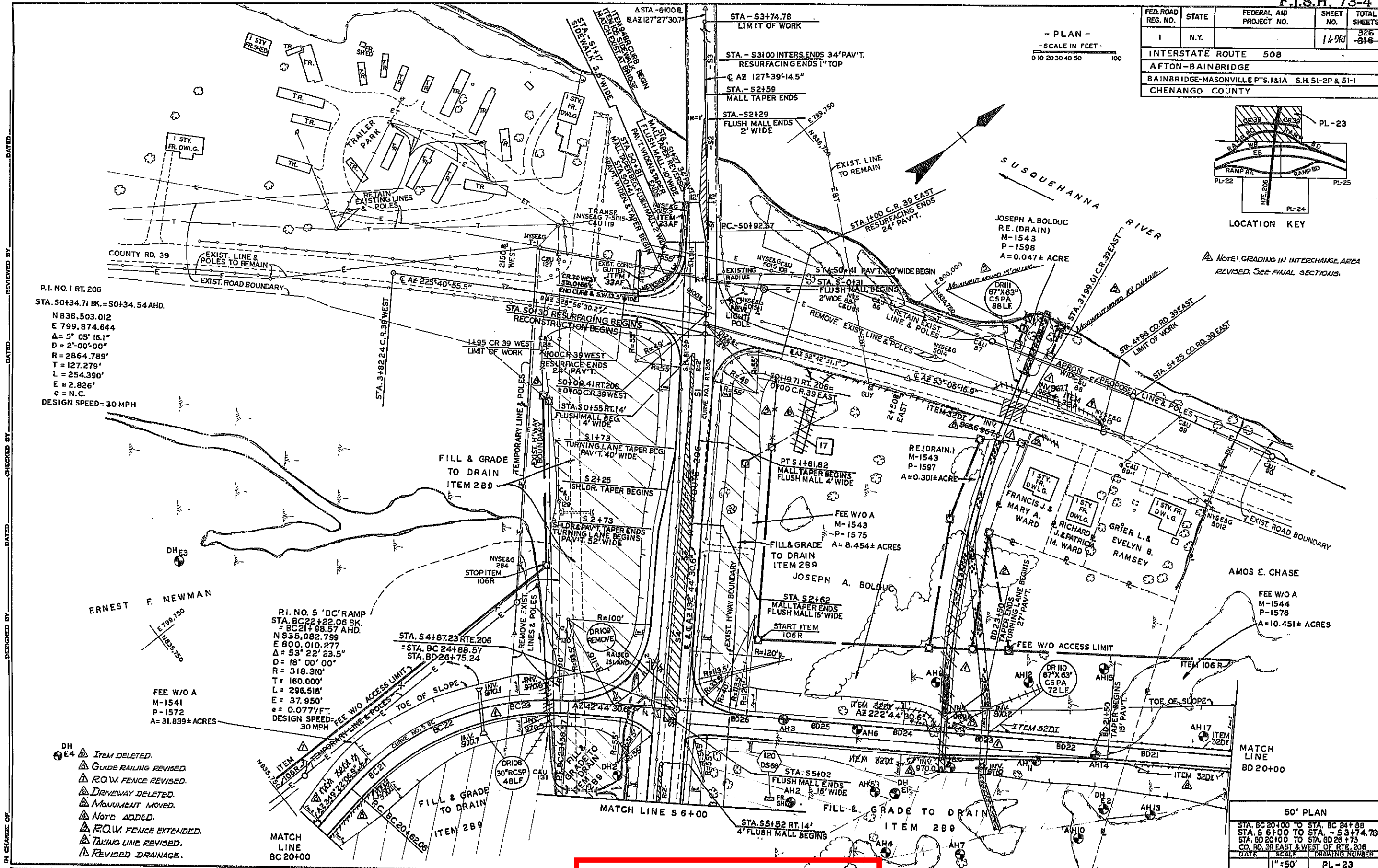

P.I. NO. 1 RT. 206
STA. 50+34.71 BK. = 50+34.54 AHD.
N 836,503.012
E 799,874.644
Δ = 5° 05' 16.1"
D = 2°-00'-00"
R = 2864.789'
T = 127.279'
L = 254.390'
E = 2.826'
e = N.C.
DESIGN SPEED = 30 MPH

P.I. NO. 5 'BC' RAMP
STA. BC22+22.06 BK. = BC21+98.57 AHD.
N 835,982.799
E 800,010.277
Δ = 53° 22' 23.5"
D = 18° 00' 00"
R = 318.310'
T = 160.000'
L = 286.518'
E = 37.950'
e = 0.0777/FT.
DESIGN SPEED = 30 MPH

FEE W/O A
M-1541
P-1572
A= 31.839± ACRES

RE (DRAIN.)
M-1543
P-1597
A= 0.301± ACRES

FEE W/O A
M-1544
P-1576
A= 10.451± ACRES

- ⊙ E4 Item Deleted.
- △ Guide Railing Revised.
- △ R.O.W. Fence Revised.
- △ Driveway Deleted.
- △ Monument Moved.
- △ Note Added.
- △ R.O.W. Fence Extended.
- △ Taking Line Revised.
- △ Revised Drainage.

DATE	SCALE	DRAWING NUMBER
	1" = 50'	PL-23

REFERENCE DRAWING
NOT TO SCALE

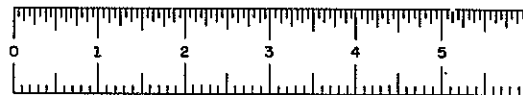

F.I.S.H. 73-4

FED. ROAD REG. NO.	STATE	FEDERAL AID PROJECT NO.	SHEET NO.	TOTAL SHEETS
1	N.Y.		1508	526

INTERSTATE ROUTE 508
 AFTON - BAINBRIDGE
 BAINBRIDGE - MASONVILLE PTS. 1&1A S.H. 51-2P&51-1
 CHENANGO COUNTY

- PLAN -
 - SCALE IN FEET -
 0 10 20 30 40 50 100

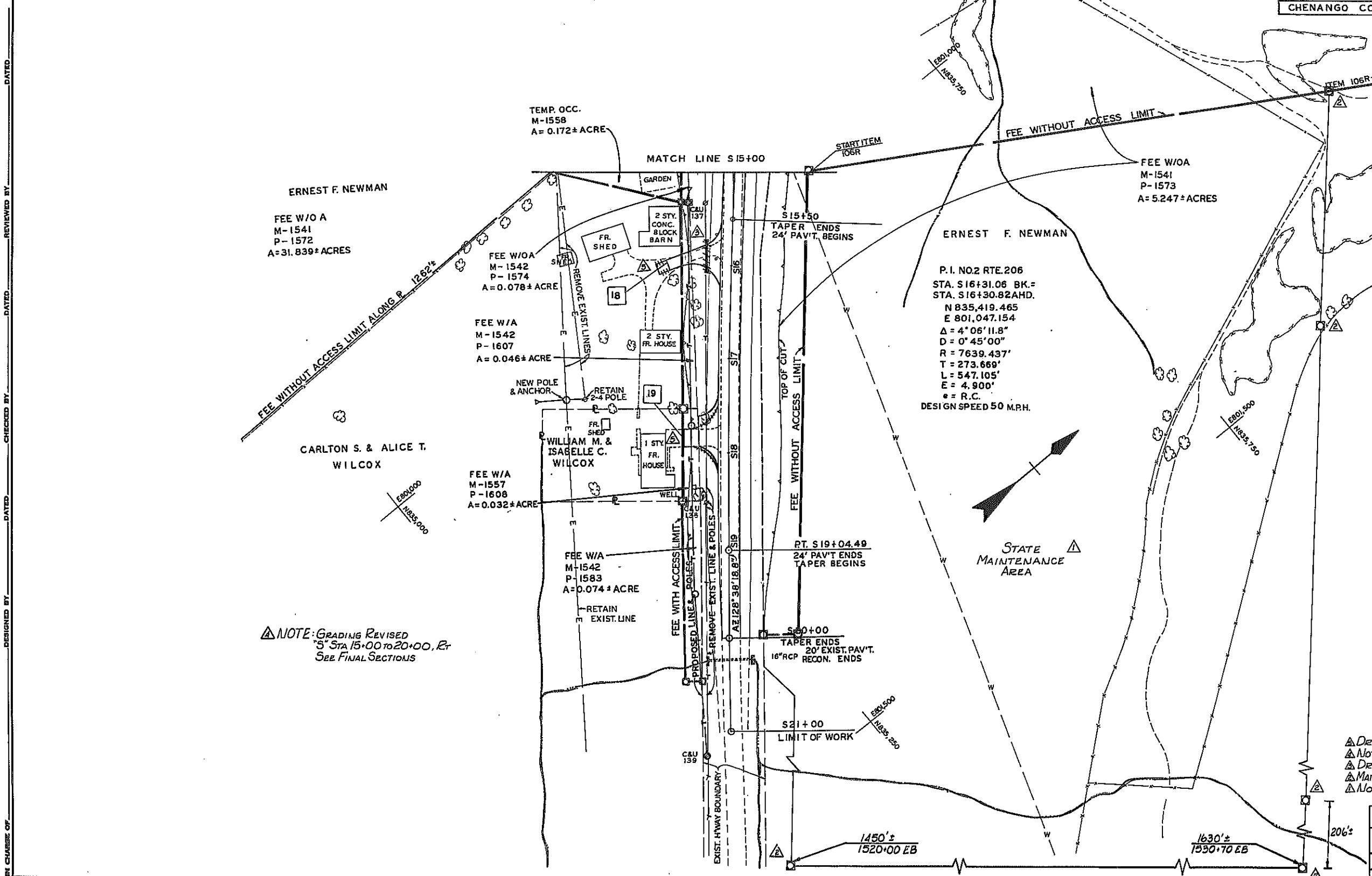
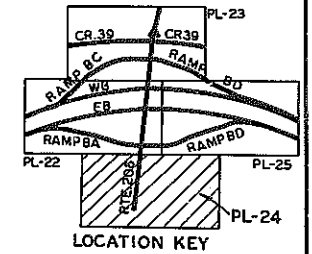

NOTE: GRADING REVISED
 S STA 15+00 TO 20+00. R.
 SEE FINAL SECTIONS

- ▲ DRIVEWAY REVISED
- ▲ NOTE ADDED
- ▲ DRIVEWAY PIPE DELETED
- ▲ MAINTENANCE AREA MONUMENTED
- ▲ NOTE ADDED

50' PLAN		
STA. S15+00 TO S 21+00		
DATE	SCALE	DRAWING NUMBER
	1" = 50'	PL-24

REFERENCE DRAWING
NOT TO SCALE

DESIGNED BY _____ CHECKED BY _____ DATED _____ REVIEWED BY _____ DATED _____



F.I.S.H. 73-4

N.Y. ROUTE 206

FED. ROAD REG. NO.	STATE	FEDERAL AID PROJECT NO.	SHEET NO.	TOTAL SHEETS
1	N.Y.		151R1	326
INTERSTATE ROUTE 508				
AFTON - BAINBRIDGE				
BAINBRIDGE-MASONVILLE PTS. 1&1A SH. 51-2P & 51-1				
CHENANGO COUNTY				

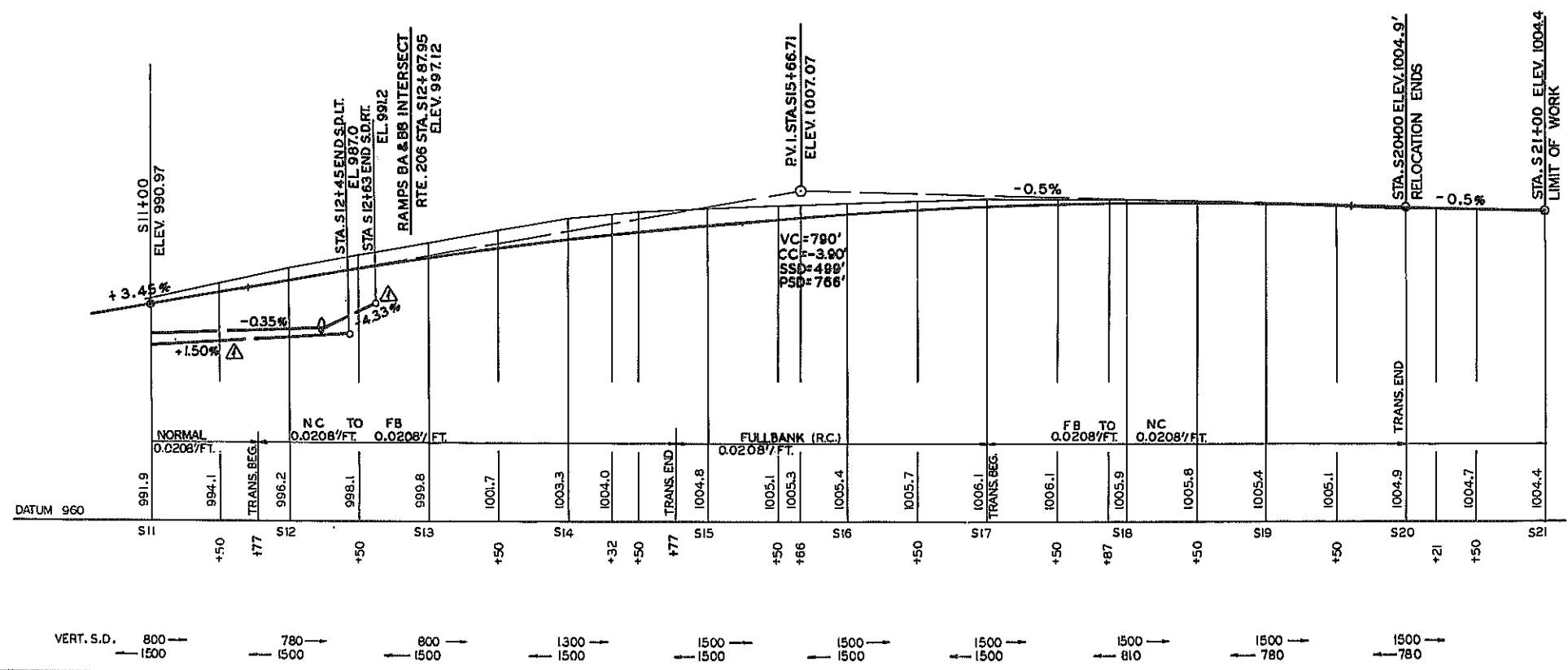
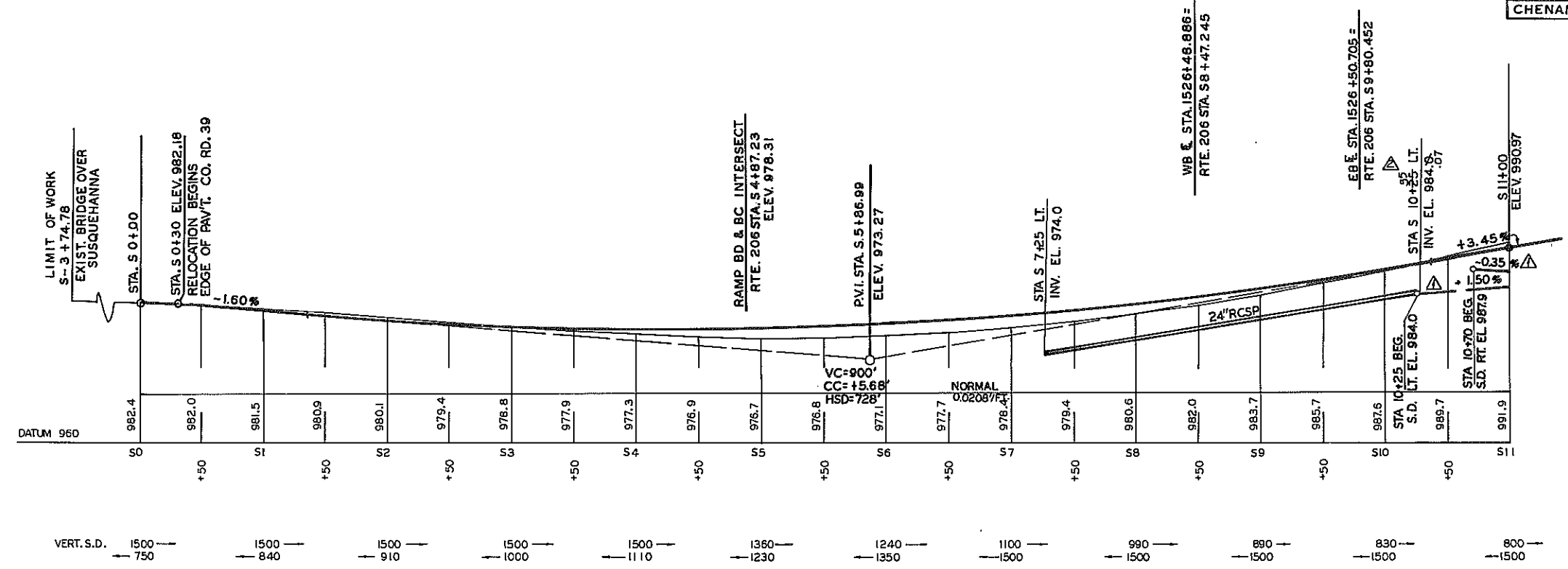
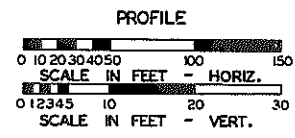

△ DRAINAGE REVISED.
 △ SEE FINAL SECTIONS FOR DITCH GRADE.

50' PROFILES		
NY ROUTE 206 50+00 - 52+00		
DATE	SCALE	DRAWING NUMBER
6/72	1"=50' HORIZ. 1"=10' VERT.	PR-30

REFERENCE DRAWING
NOT TO SCALE

DESIGNED BY: _____ CHECKED BY: _____ DATED: _____ REVIEWED BY: _____ DATED: _____ IN CHARGE OF: _____

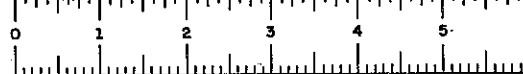

FED. RD. DIST. NO.	STATE	FEDERAL AID PROJECT NO.	SHEET NO.	TOTAL SHEETS
1	NEW YORK		287A	316

INTERSTATE ROUTE 508
AFTON - BAINBRIDGE
CHEMUNG COUNTY

PI 1574.00
VC 3800
CC 13.05
SSD 1242'
Elev 116.011

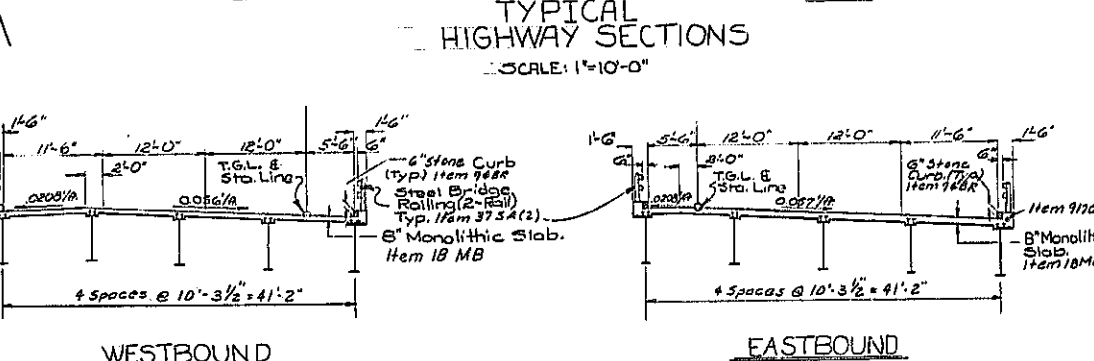
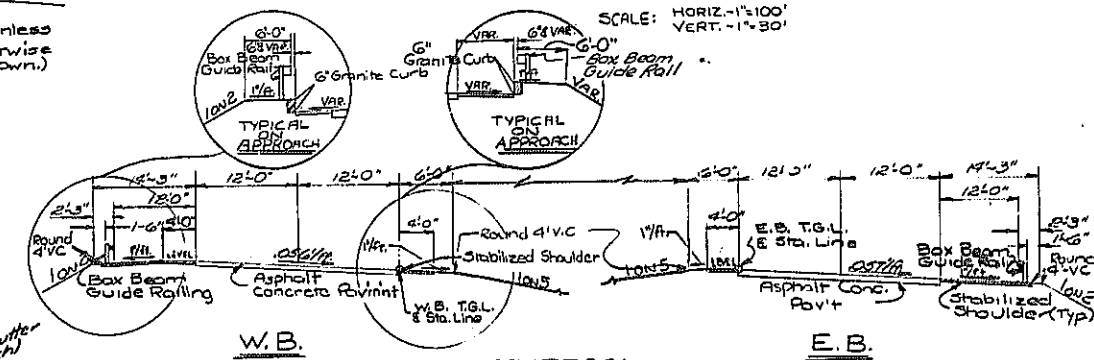
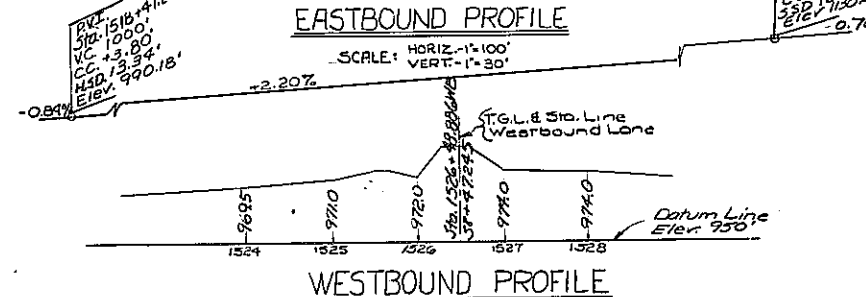
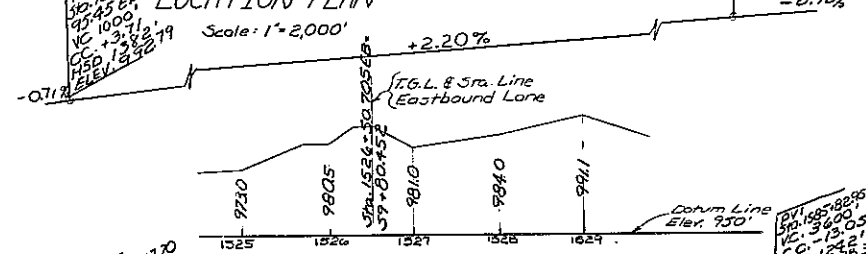
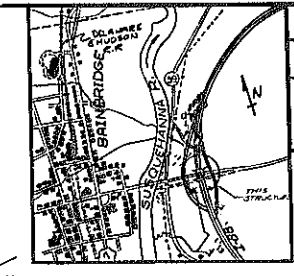
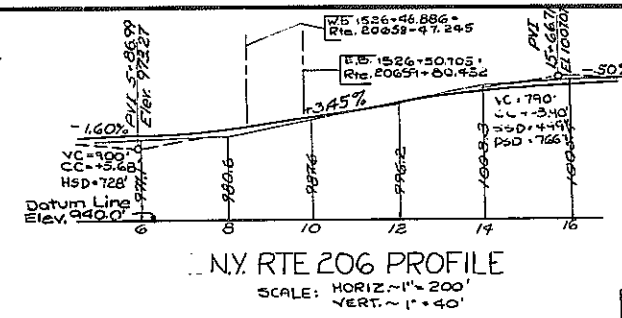

FOUNDATION TREATMENT
The Abutments shall be supported on spread footings placed on compacted Item 2VJ-E with a maximum allowable bearing pressure of 2 1/2 Tons per square foot.

- △ D.I. DELETED
- △ GRADING VARIES, SEE FINAL SECTIONS
- △ SOO GUTTER DELETED

BRIDGE NO. 4
INTERSTATE ROUTE 508
Over
ROUTE 206

PLAN, ELEVATION, PROFILES AND SECTIONS

DRAWING NO. 1 OF 30

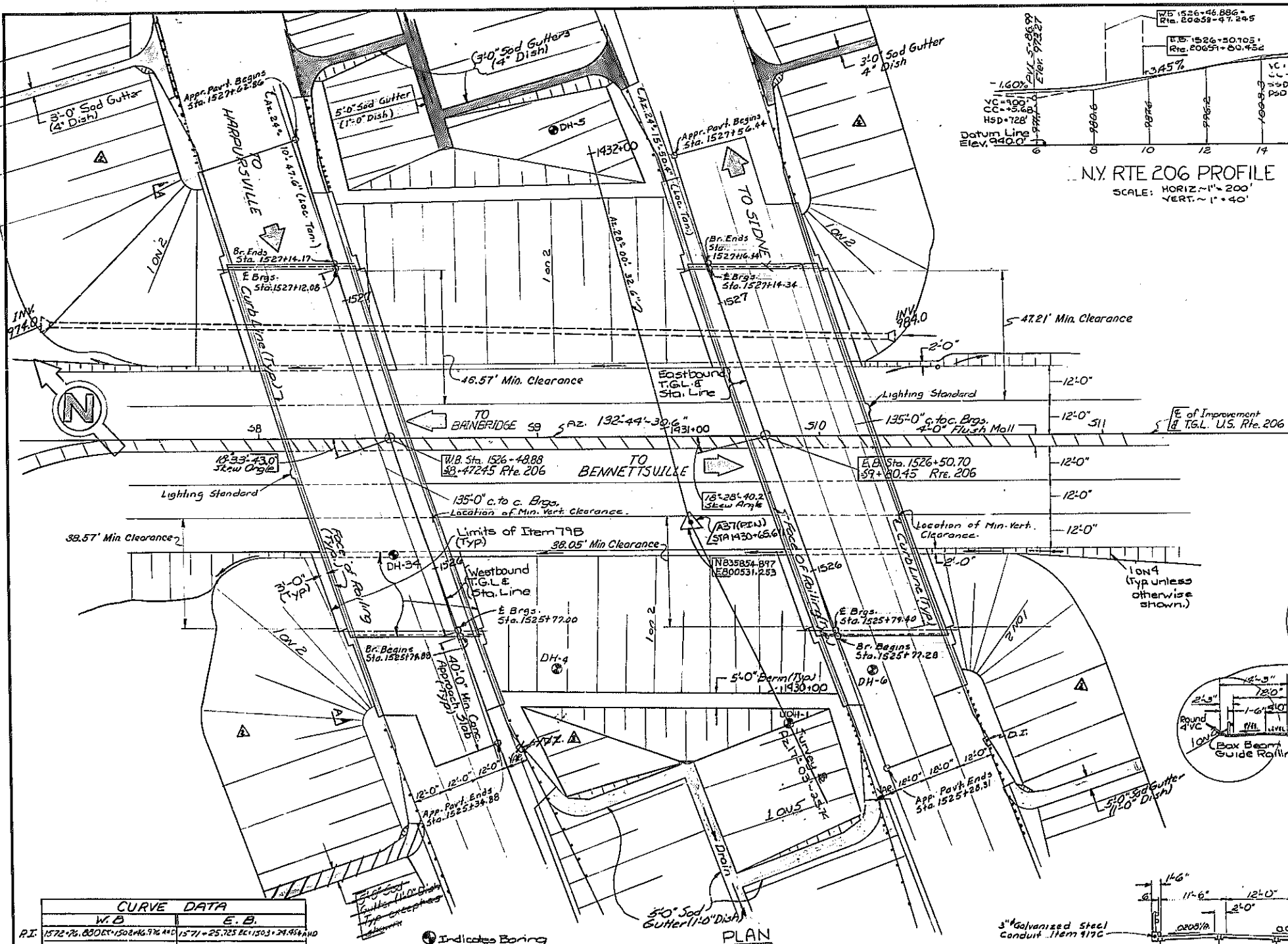

CURVE DATA	
W.B.	E.B.
PI 1572.76	PI 1571.25
VC 1508.96	VC 1503.29
CC 1509.45	CC 1507.71
SS 130°-17'-59"	SS 130°-10'-27"
CS 1°-40'-00"	CS 1°-43'-00"
RS 3937.747'	RS 3337.618'
LS 7617.982'	LS 7382.962'
IS 7523.944'	IS 7287.111'
OS 1°-40'-00"	OS 1°-43'-00"
LS 200.00'	LS 200.00'
ES 7743.721'	ES 7586.881'
e 0.056 1/H	e 0.057 1/H

Indicates Boring Locations.

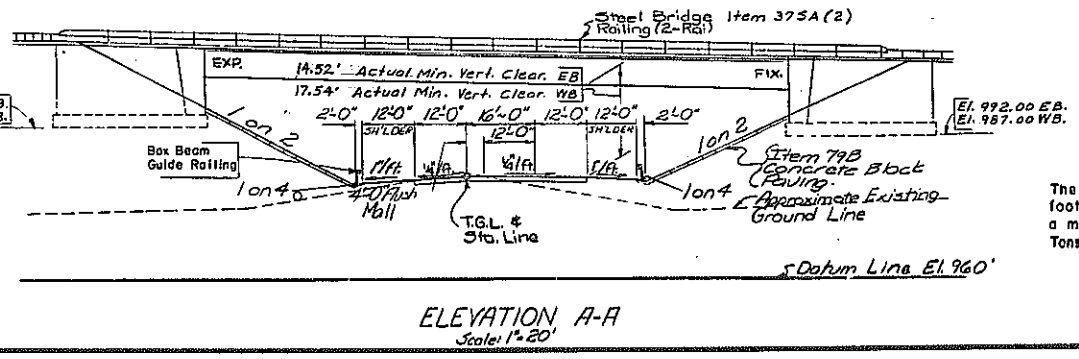

PROJECT ENGINEER: J. De Masi
IN CHARGE OF: J. De Masi
DESIGNED BY:
DESIGN CHECKED BY:
DETAILED BY: Thomas E. Petrovsky
DETAIL CHECKED BY: S.G. Gerardo

REFERENCE DRAWING
NOT TO SCALE



FED. RD. REG. NO.	STATE	FEDERAL AID PROJECT NO.	SHEET NO.	TOTAL SHEETS
1	NEW YORK		289	316

INTERSTATE ROUTE 508
AFTON - BAINBRIDGE
CHENANGO COUNTY

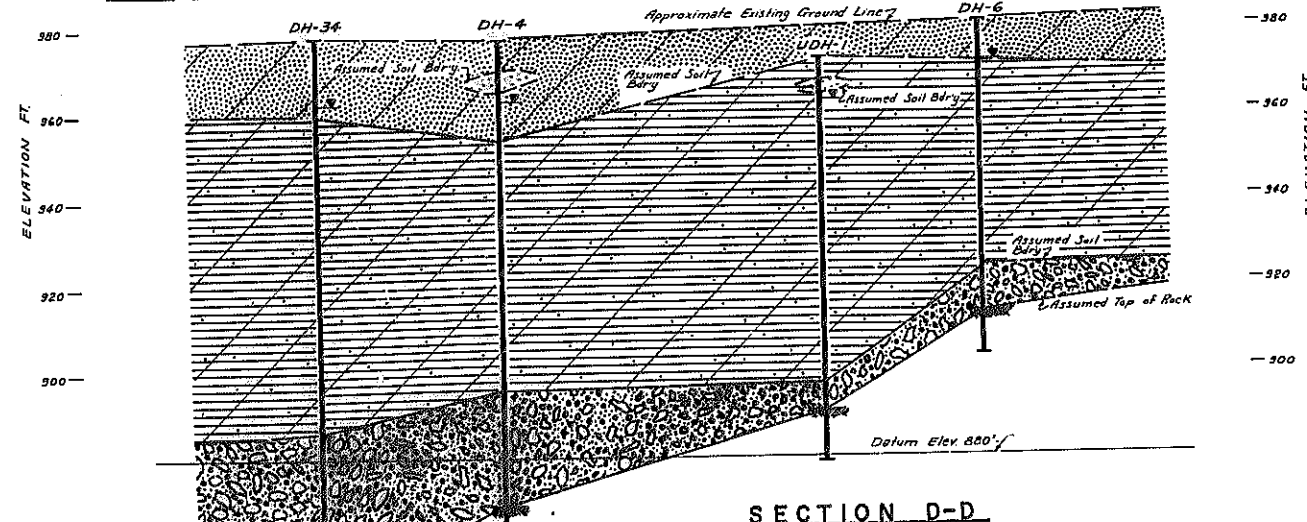
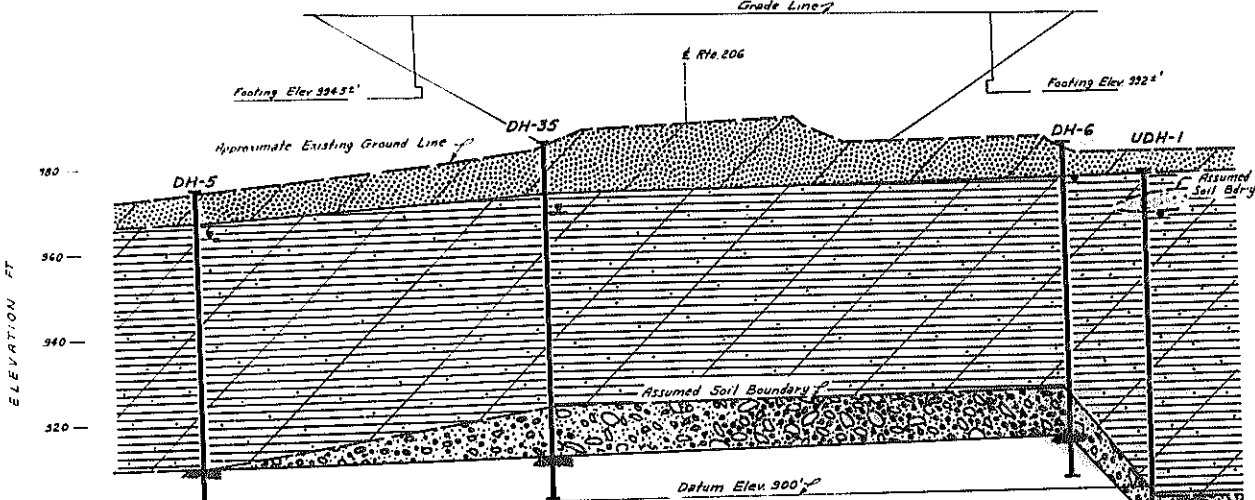
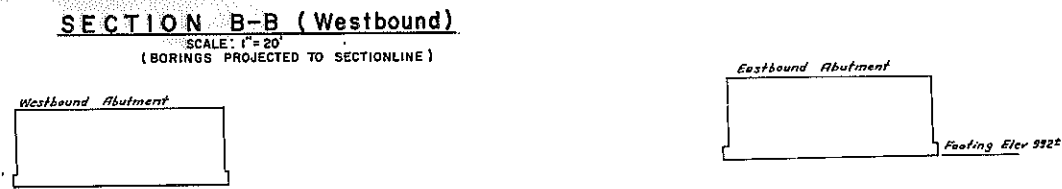
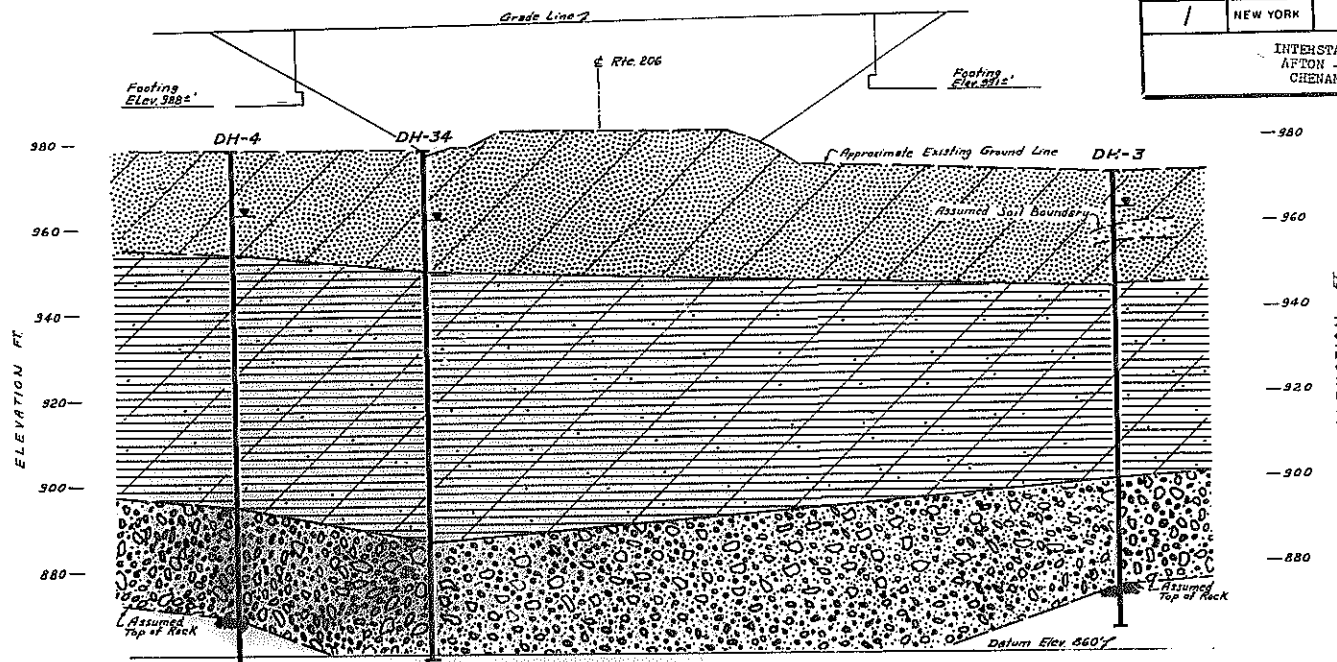
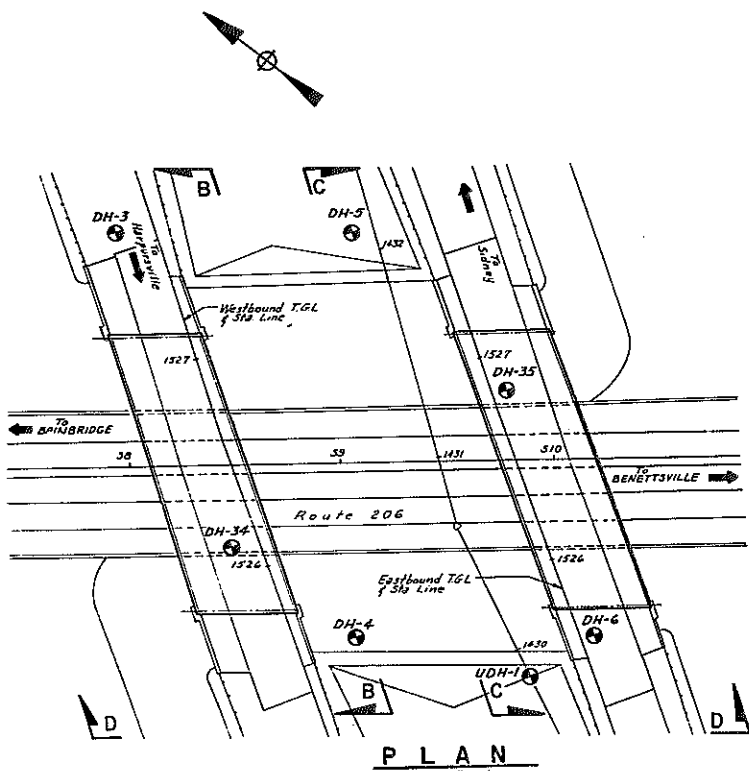

GENERAL NOTES

- The subsurface explorations shown hereon were made between December 10, (BORINGS PROJECTED TO SECTIONLINE) 1969 and June 18, 1971 by Regional Soils Section.
- 1) General Soil Strata descriptions and indicated boundaries are based on interpretation of all available subsurface information and may not necessarily show the actual variation in subsurface conditions between borings and samples.
 - 2) The observed water levels and/or conditions indicated on the soil profiles are as recorded at the time of drilling. These water levels and/or conditions may vary considerably, with time, according to the prevailing climate, rainfall and other factors.
 - 3) Sound engineering judgment was exercised in preparing the subsurface information presented hereon. This information was prepared and is intended for State design purposes only. Its presentation on the plans or elsewhere is for the purpose of providing others with access to the identical information available to the State. This information is presented in good faith but is not intended as a substitute for personal investigation, interpretations or judgment of the Contractor.
 - 4) All structure details shown hereon are for illustrative purposes only and may not be indicative of the final design conditions shown in the contract plans.
 - 5) Footing elevations shown are as indicated at the time of this drawing's preparation.

LEGEND

The following tables summarize the descriptive information used on this profile.

Density (Non Plastic Soils)	Avg. No. of Blows per foot for 18 in. drop of 300 lb. hammer 2 in. O.D. Sampler	Amount of Component Material Primary Component Capitalized
Very Loose	0-3	"sand" 50% to 40% of secondary component
Loose	3-8	"soma" 40% to 10% " "
Medium Compact	8-20	"trace" 10% to less " "
Compact	20-35	
Very Compact	over 35	

Consistency (Plastic Soils)	
Very Soft	0-2
Soft	2-6
Firm	6-12
Stiff	12-20
Hard	over 20

SYMBOLS

- observed water level
- Loose to Medium Compact Brown and Grey GRAVEL, SAND, and SILT with a trace of clay.
- Soft Brown and Grey SILT with some Organic Material with a trace of clay and sand with wood.
- Soft to firm Brown and Grey SILT with a trace of clay and Sand; thin SILT with some Clay.
- Medium Compact to Very Compact Brown SAND with some Silt and Gravel and a trace of clay.
- Bedrock

DESIGN INFORMATION

PRELIMINARY STRUCTURE PLANS USED FOR ANALYSIS
 PREPARED BY: The Structure Design and Construction Subdivision
 SCALE: 1"=20' DATE: 5-19-72
 PREPARED BY: *John Wilco*
 DRAWN BY: *R. Paulina*
 CHECKED BY: *Robert C. Houghton*

STATE OF NEW YORK
DEPARTMENT OF TRANSPORTATION

SOILS MECHANICS BUREAU
 INTERSTATE ROUTE 508 (I88)
 AFTON - BAINBRIDGE
 PIN 9357.03.III
 GENERAL SUBSURFACE PROFILE FOR
 BRIDGE # 4 MAINLINE OVER ROUTE 206
 APPROVED *John P. Houghton* JUNE 7 1972
 DIRECTOR
 REGION NO. 9
 COUNTY CHENANGO
 DRAWING NO. 3 of 30

REFERENCE DRAWING NOT TO SCALE

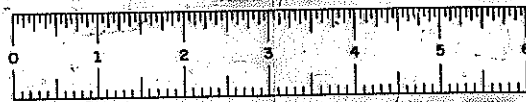

FED. RD. REG. NO.	STATE	FEDERAL AID PROJECT NO.	SHEET NO.	TOTAL SHEETS
1	NEW YORK		291	316

INTERSTATE ROUTE 508
 APTON - BAINBRIDGE
 CHERANGO COUNTY

EMBANKMENT NOTES

- For design purposes the foundation pressure shall not exceed 2½ tons per square foot.
- The following waiting periods shall originate when the embankments are constructed to subgrade of roadway including the abutment area.

SOUTH ABUTMENTS -
 Three (3) months prior to excavating, constructing and backfilling the abutment.
 Five (5) months prior to setting the pedestals and sidewalk overlays.

NORTH ABUTMENTS -
 Two (2) months prior to excavating for and constructing the complete abutment.

- Settlement platforms shall be installed at the following locations:

B/L Station	Offset (feet)
1430 + 05	25 Rt.
1431 + 85	95 Lt.

Settlement readings shall be taken weekly during construction and the waiting periods and forwarded to the Soil Mechanics Bureau for interpretation. The settlement platforms shall be paid for under Item 21G and included in the Highway Estimate. Waiting periods may be reduced based on interpretation of the settlement platform readings.

- For additional substructure notes see Common Details Drawing No. 1 OF 3.

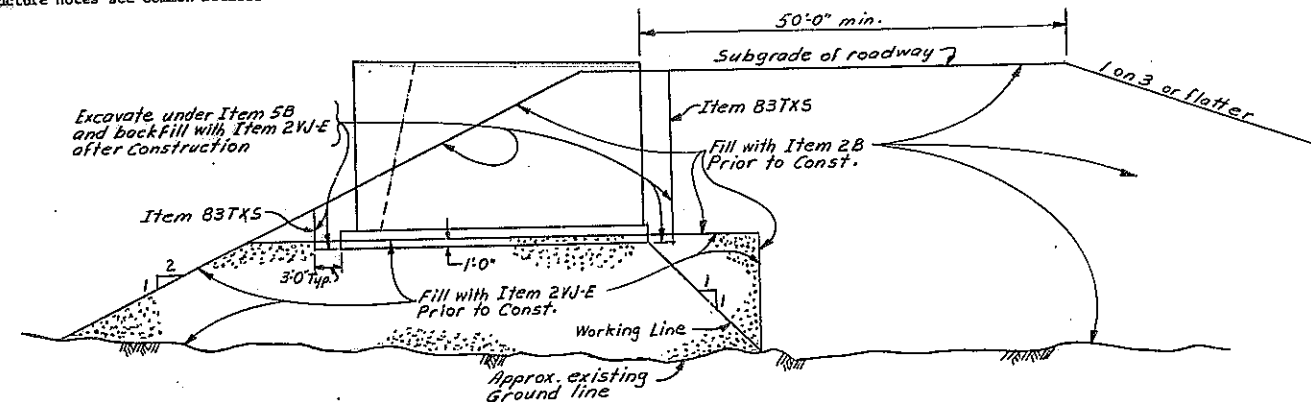
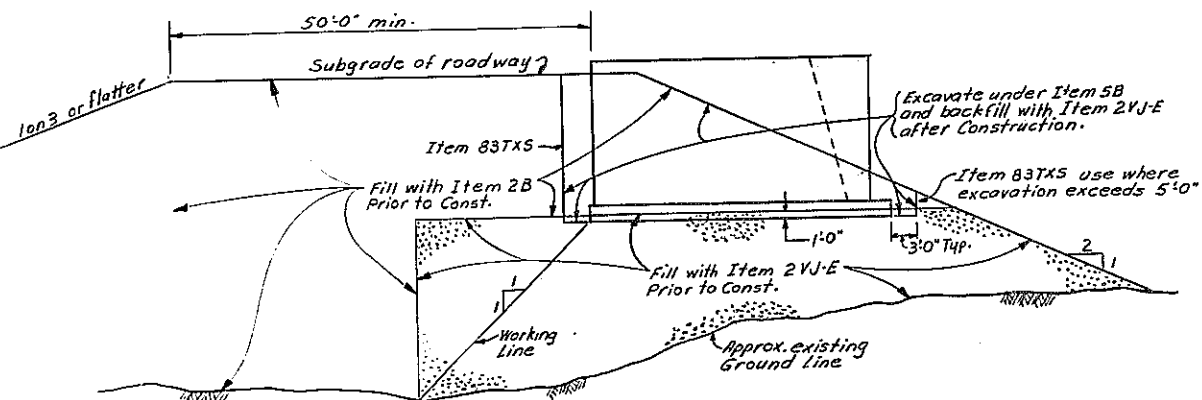

SECTION A-A
 SCALE 1" = 10'-0"

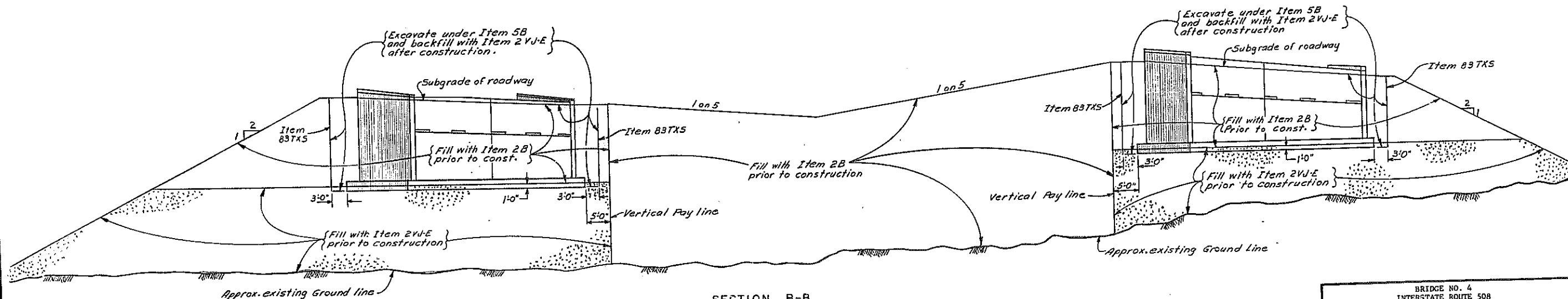

PROJECT ENGINEER E. P. Locker
 IN CHARGE OF E. E. Hall, Jr.
 DESIGNED BY _____
 DESIGN CHECKED BY _____
 DETAILED BY W.L.
 DETAIL CHECKED BY C. C. Hall, Jr.

BRIDGE NO. 4
 INTERSTATE ROUTE 508
 over
 ROUTE 206
 EXCAVATION & EMBANKMENT
 SECTIONS
 DRAWING NO. 5 OF 30

REFERENCE DRAWING
 NOT TO SCALE

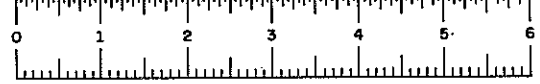

FED. RD. REG. NO.	STATE	FEDERAL AID PROJECT NO.	SHEET NO.	TOTAL SHEETS
1	NEW YORK		292	316

INTERSTATE ROUTE 508
APTON - BAINBRIDGE
CHEMUNGO COUNTY

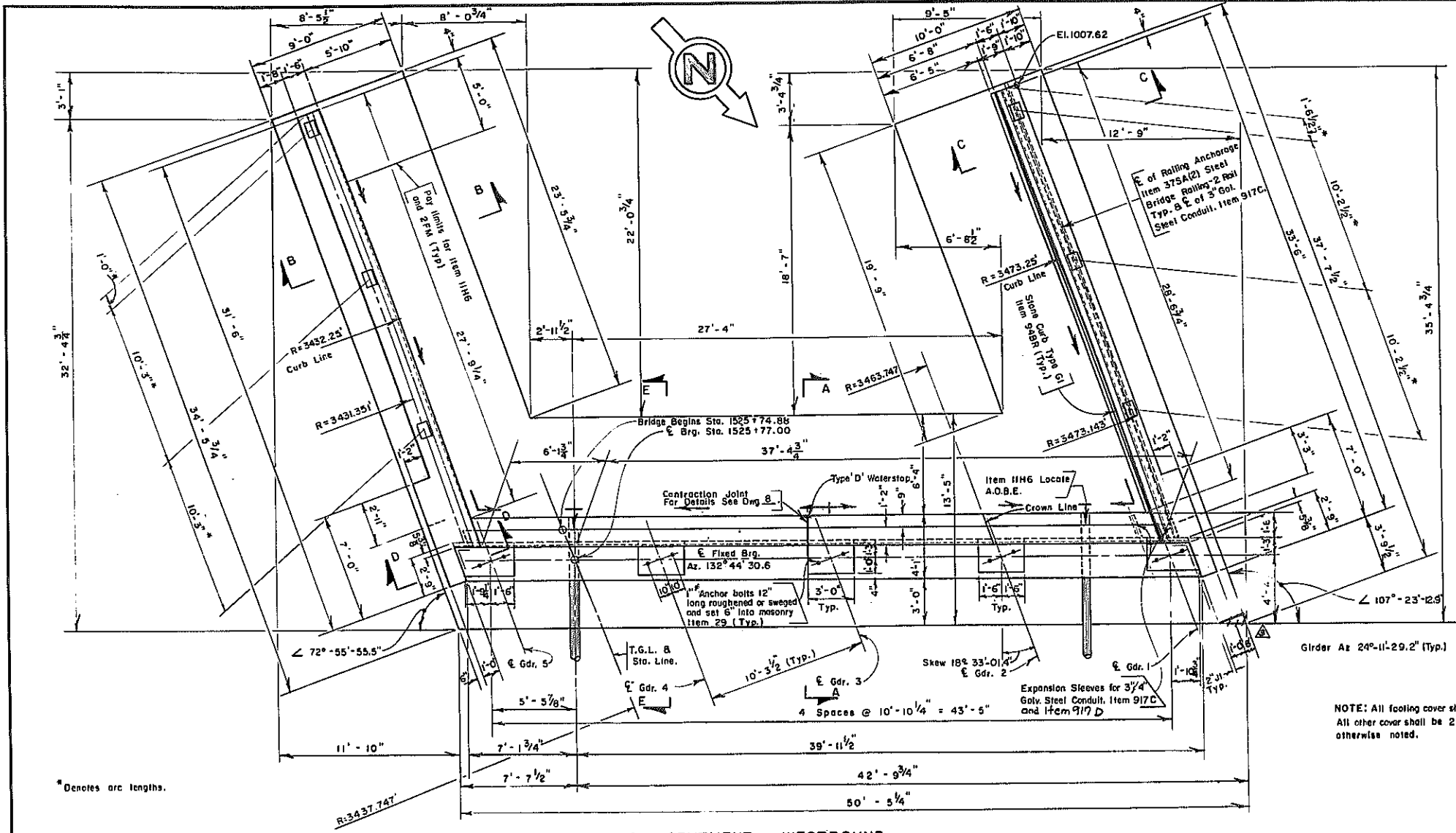

PLAN SOUTH - ABUTMENT WESTBOUND
Scale: 1/4" = 1'-0"

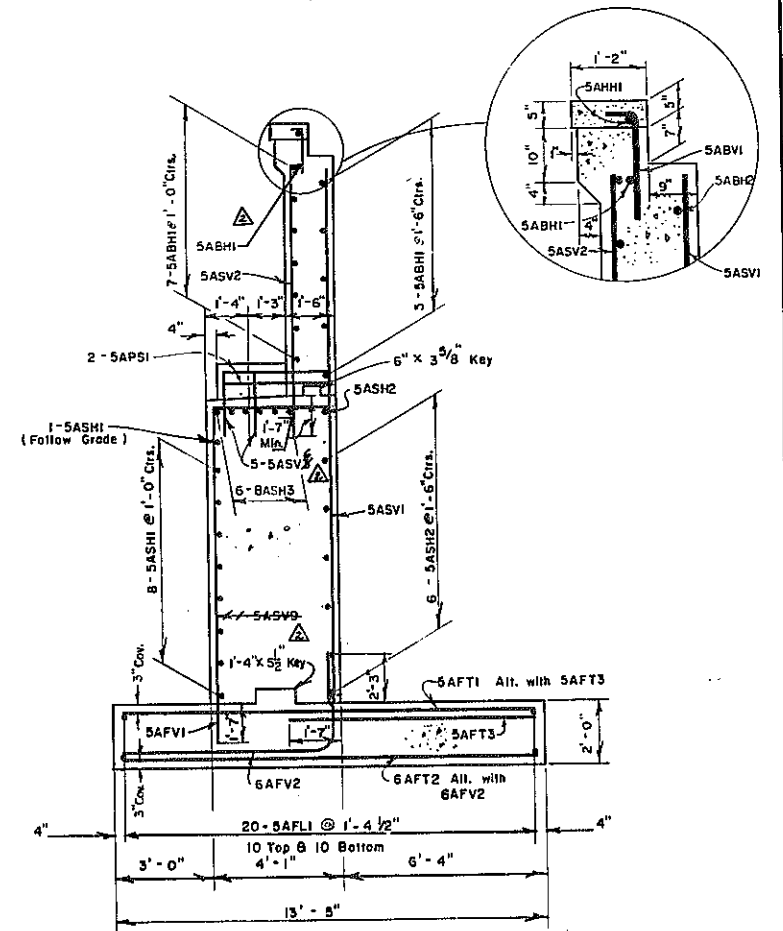

SECTION E-E
Scale: 3/8" = 1'-0"

ESTIMATE BREAKDOWN			
LOCATION	ITEM 1B	ITEM 20	ITEM 28D
FOOTING		80.7 C.Y.	7436.1 Lb.
SE ABUT. STEM	.8 C.Y.	59.7 C.Y.	3619.8 Lb.
SW ABUT. STEM	.8 C.Y.	71.4 C.Y.	3913.0 Lb.
SE BACKWALL	.8 C.Y.	9.8 C.Y.	406.3 Lb.
SW BACKWALL	1.2 C.Y.	10.4 C.Y.	469.9 Lb.

For Section A-A see Dwg. No. 13 (Footing dimensions and elevations do not apply.)
 For Rolling Details see Common Detail Dwg. No. 8.
 For Stone Curb Details see Common Details No. 3.
 For Section B-B, C-C, & D-D, see Dwg. No. 6.
 For Armored Joint Details see Common Details Dwg. No. 4B.5.
 For Details of Lighting and Telephone Conduits, see Dwg. No. 27 and Common Details Dwg. No. 2.

- ▲ SHARP CORNER ELIMINATED
- ▲ REBARS REVISED
- ▲ AS BUILT PEDESTAL GRADES & SHIMS NOTED

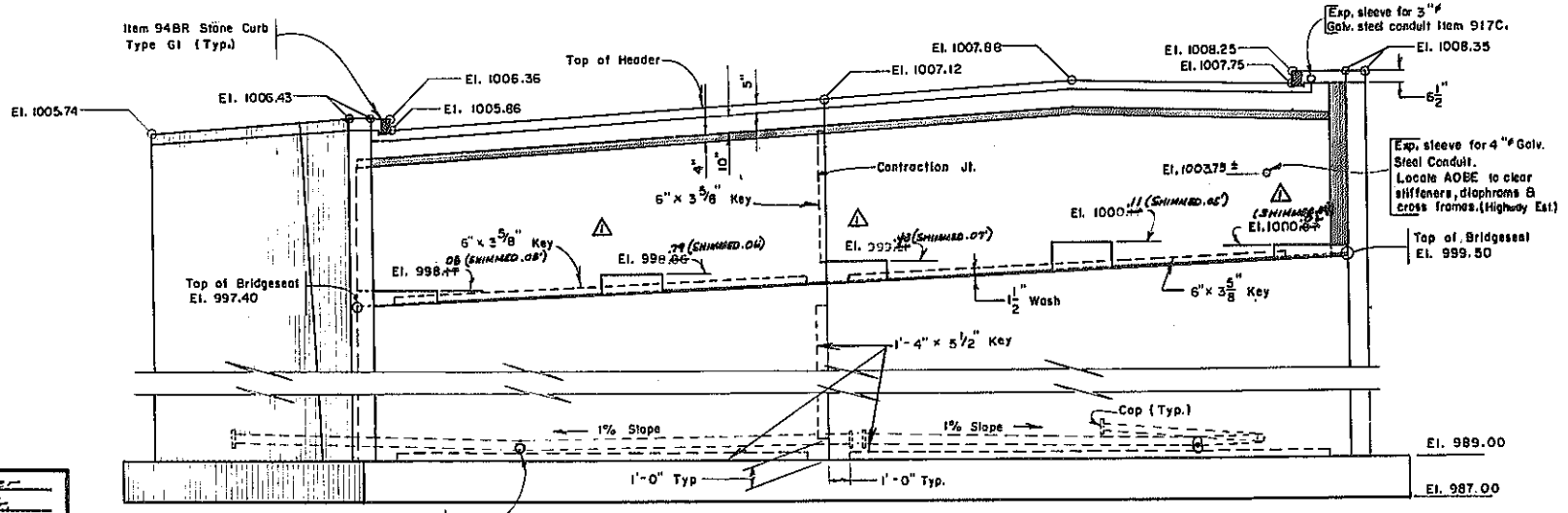

ELEVATION
Scale: 1/4" = 1'-0"

For design purposes the foundation pressure does not exceed 2 1/2 tons per square foot.

PROJECT ENGINEER: E.A. Hooper
 IN CHARGE OF: G.C. Hall, Jr.
 DESIGNED BY: F. Hoop
 DESIGN CHECKED BY: A. Baker
 DETAILED BY: Richard J. Clements
 DETAIL CHECKED BY: G.C. Hall, Jr.

BRIDGE NO. 4
 INTERSTATE ROUTE 508
 OVER
 ROUTE 206
 SOUTH ABUTMENT-WFSTBOUND
 DRAWING NO. 6 OF 30

REFERENCE DRAWING
NOT TO SCALE

FED. NO. REG. NO.	STATE	FEDERAL AID PROJECT NO.	SHEET NO.	TOTAL SHEETS
1	NEW YORK		295	316
INTERSTATE ROUTE 508 AFTON - BAINBRIDGE CHEMUNGO COUNTY				

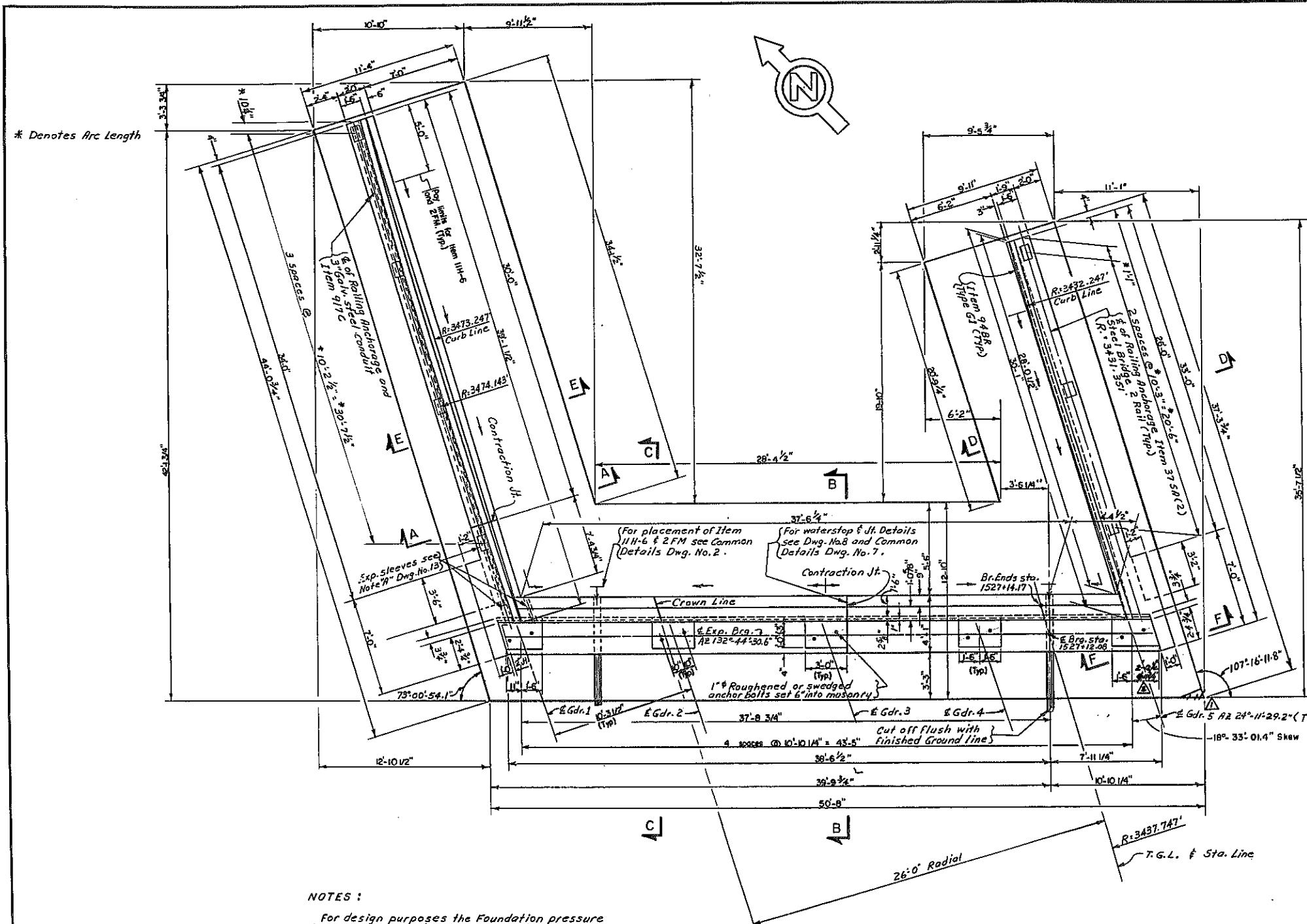

NOTES:

- For design purposes the Foundation pressure does not exceed 2 1/2 Tons per sq. ft.
- For Railing Details, see Common Details Dwg. No. 8
- For Stone Curb Detail, see Common Details Dwg. No. 3
- For Railing Layout, see Dwg. No. 24
- For Waterstop Details, see Common Details Dwg. No. 7
- For Sections C-C, D-D, E-E and F-F, see Dwg. No. 11
- For Armored Joint Details see Common Details Dwg. No. 4 and 5.
- For Details of Lighting and Telephone Conduits see Dwg. No. 27 and Common Details Dwg. No. 2

PROJECT ENGINEER F.A. Leaker
 IN CHARGE OF C.C. Hoyle
 DESIGNED BY T.A. Mann
 DESIGN CHECKED BY A. Baker
 DETAILED BY K. Edwards
 DETAIL CHECKED BY A. Baker

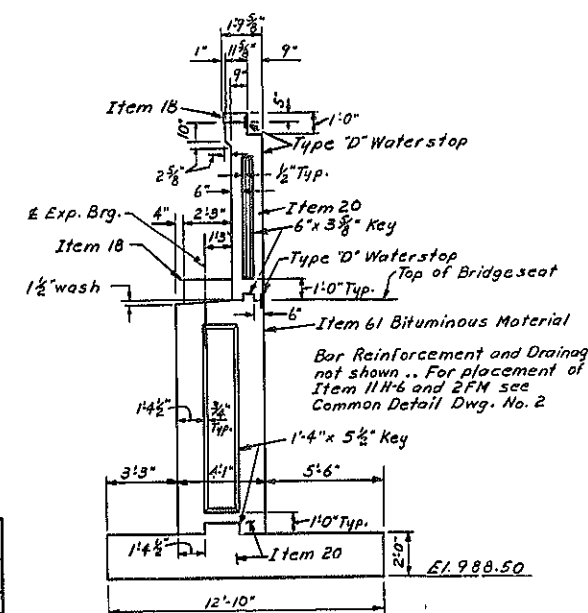
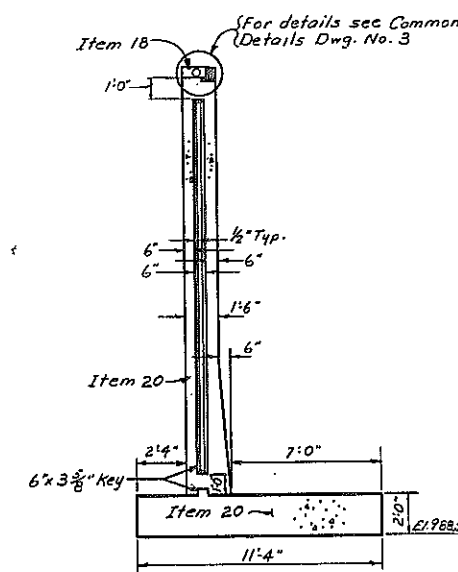

ESTIMATE BREAKDOWN			
LOCATION	ITEM 18	ITEM 20	ITEM 28D
FOOTING		91.7 C.Y.	9950.8 C.Y.
N.W. WINGWALL STEM	.62 C.Y.	36.8 C.Y.	2803.3 C.Y.
N.W. ABUT. STEM	.34 C.Y.	55.9 C.Y.	2767.2 C.Y.
N.E. ABUT. STEM	.82 C.Y.	69.3 C.Y.	4195.8 C.Y.
N.W. BACKWALL	1.12 C.Y.	11.6 C.Y.	500.0 C.Y.
N.E. BACKWALL	.73 C.Y.	9.6 C.Y.	418.5 C.Y.

BRIDGE NO. 4
 INTERSTATE ROUTE 508
 over
 ROUTE 206
 NORTH ABUTMENT-WESTBOUND
 DRAWING NO. 2 OF 30

△ DIMENSION CORRECTED
 △ SHARP CONCRETE CORNER DELETED

REFERENCE DRAWING
NOT TO SCALE



FED. RD. REG. NO.	STATE	FEDERAL AID PROJECT NO.	SHEET NO.	TOTAL SHEETS
1	NEW YORK		299R	316

INTERSTATE ROUTE 508
AFTON - HAINESBURG
CHENANGO COUNTY

ESTIMATE BREAKDOWN			
LOCATION	ITEM 18	ITEM 20	ITEM 28D
FOOTING		62.9 C.Y.	4798 Lb.
SE. ABUTMENT STEM	.6 C.Y.	38.4 C.Y.	2377 Lb.
SW. ABUTMENT STEM	.8 C.Y.	54.3 C.Y.	3312 Lb.
SE. BACKWALL STEM	.8 C.Y.	9.8 C.Y.	474 Lb.
SW. BACKWALL STEM	1.0 C.Y.	10.0 C.Y.	515 Lb.

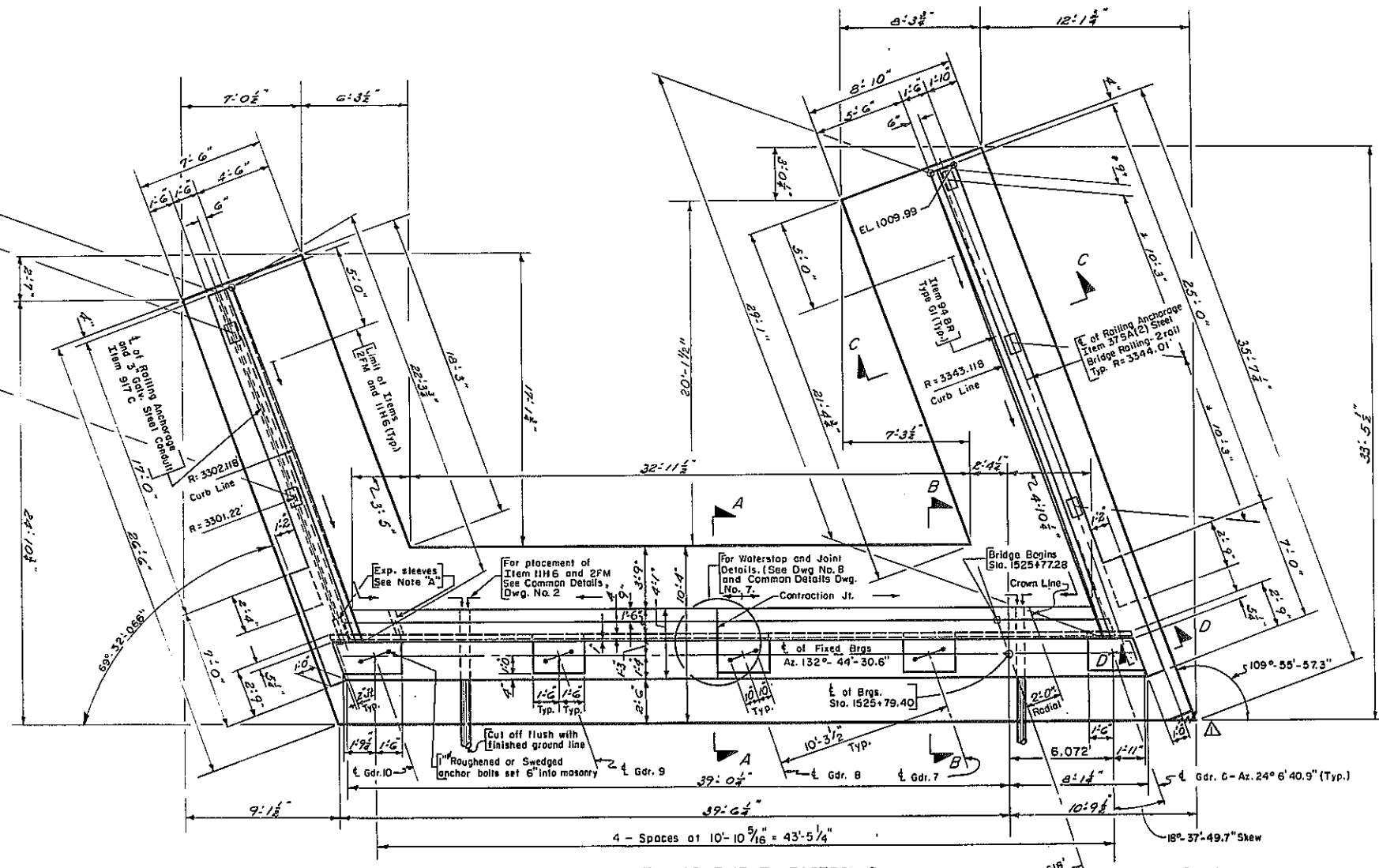

* Denotes Arc Length

Note A
Expansion sleeves for 3" & 4" Galv. steel conduit. For Details see Dwg. No. 27 and Common Details Dwg. No. 2.

PLAN - SOUTH ABUTMENT EASTBOUND
Scale: 1/4" = 1'-0"

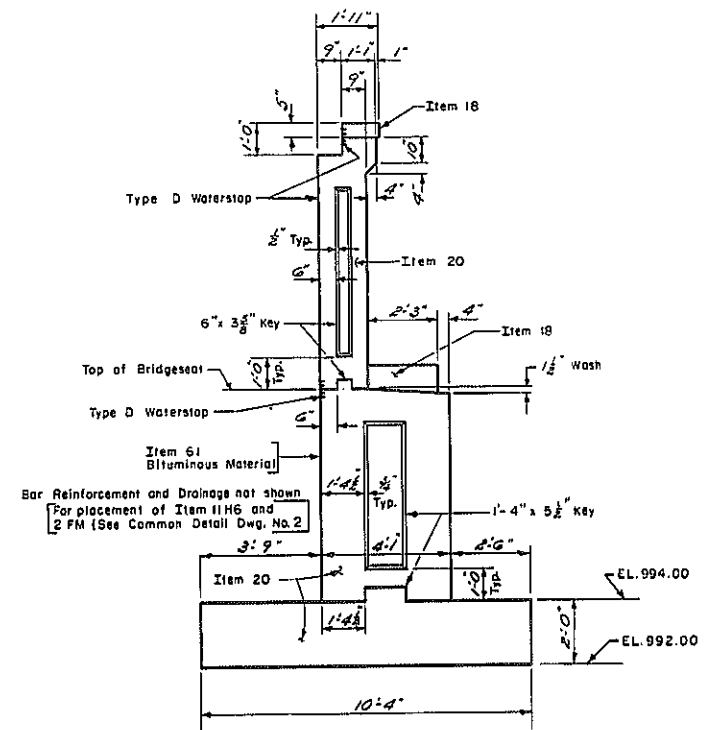

SECTION A-A
Scale: 3/8" = 1'-0"

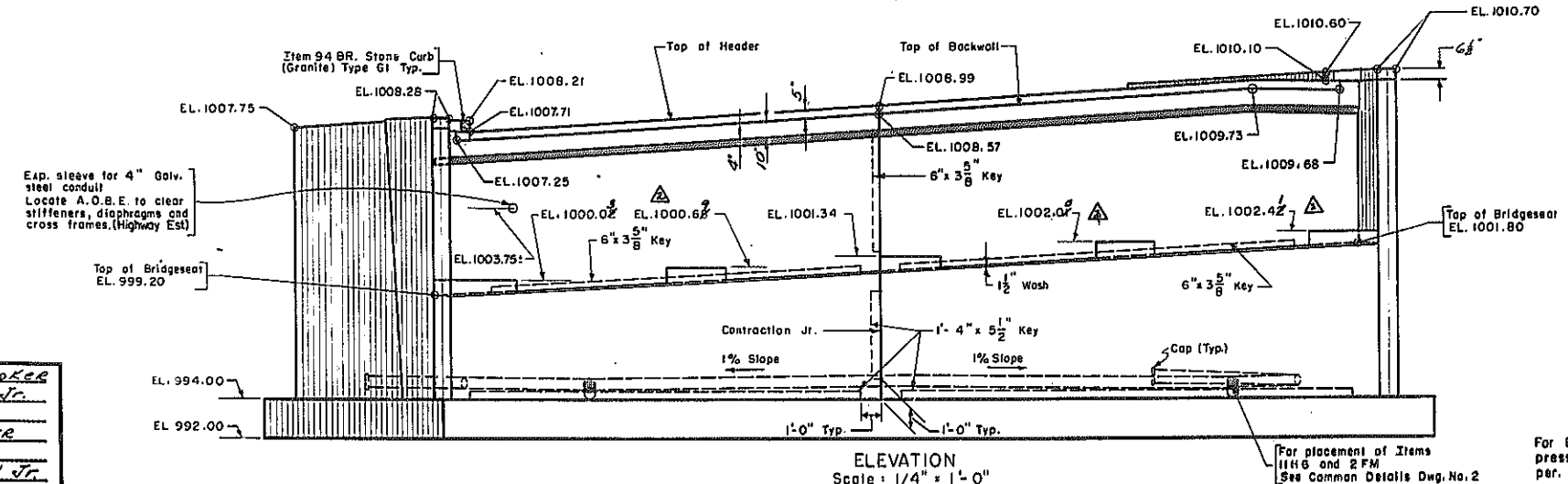

ELEVATION
Scale: 1/4" = 1'-0"

PROJECT ENGINEER F.A. Looker
IN CHARGE OF C.A. Hall Jr.
DESIGNED BY T. Mann
DESIGN CHECKED BY A. Baker
DETAILED BY A. Baker
DETAIL CHECKED BY C.C. Hall Jr.

For Railing Details see Common Details Dwg. No. 8
For Stone Curb Detail, See Common Details Dwg. No. 3
For Railing Layout, See Dwg. No. 24
For Waterstop Details, See Common Details Dwg. No. 7

AS BUILT PEDESTAL GRADES NOTED
SHARP CONCRETE CORNER DELETED
For Sections B-B, C-C and D-D See Dwg. No. 15
For Armored Joint Details see Common Details Dwg. No. 4 and 5.
For Details of Lighting and Telephone Conduits See Dwg. No. 27 and Common Details Dwg. No. 2.

BRIDGE NO. 4
INTERSTATE ROUTE 508
over
ROUTE 206
SOUTH ABUTMENT - EASTBOUND
DRAWING NO. 13 OF 30.

For Design purposes the Foundation pressure does not exceed 2 1/2 Tons per sq. Ft.

REFERENCE DRAWING
NOT TO SCALE

FED. RD. REG. NO.	STATE	FEDERAL AID PROJECT NO.	SHEET NO.	TOTAL SHEETS
1	NEW YORK		302R1	316

INTERSTATE ROUTE 508
AFTON - BAIERIDGE
CHENANGO COUNTY

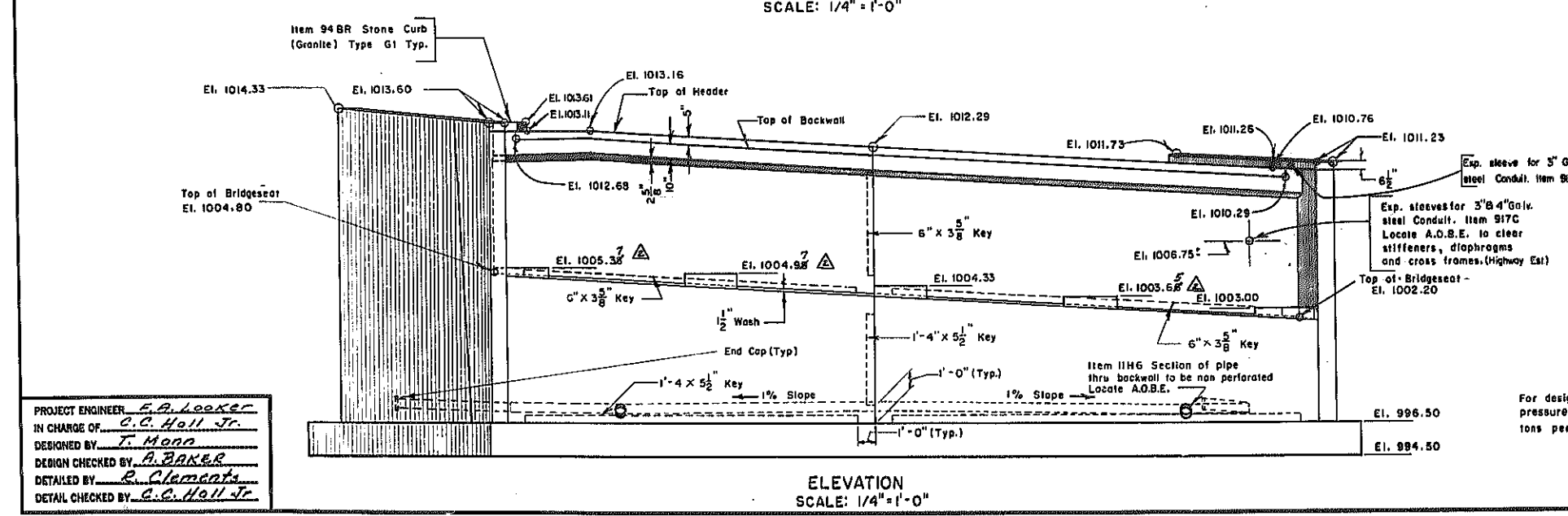
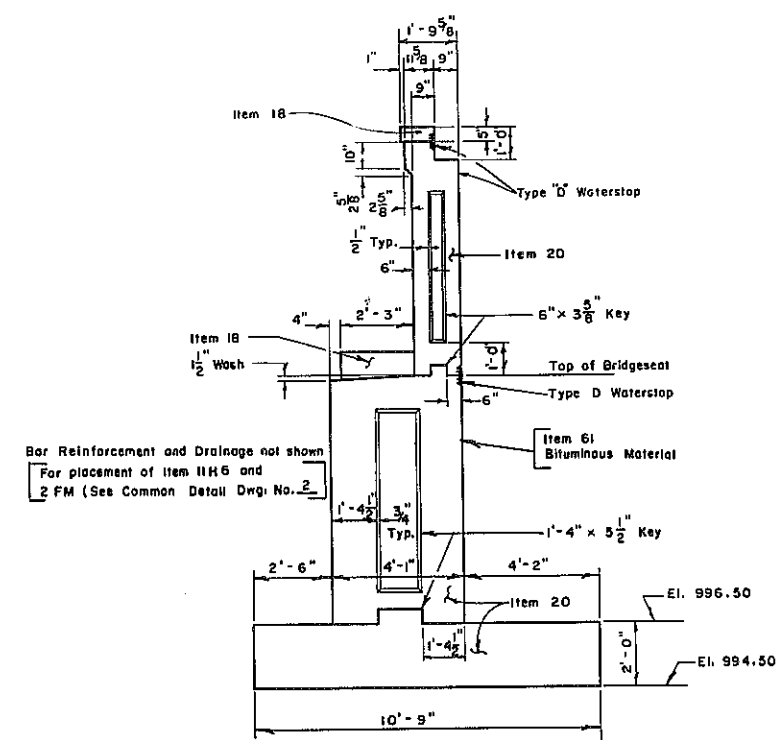
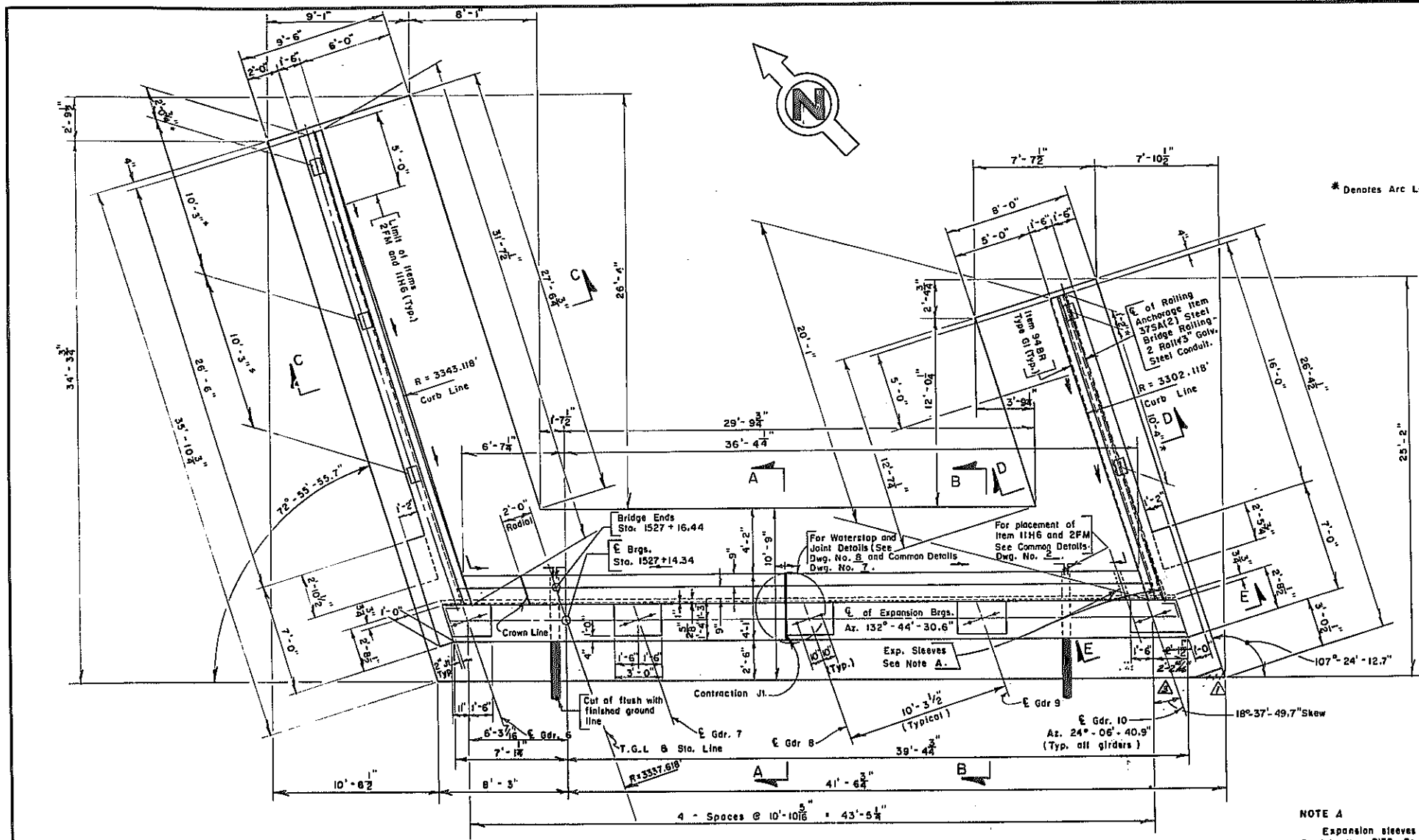

ESTIMATE BREAKDOWN			
LOCATION	ITEM 18	ITEM 20	ITEM 28D
FOOTING		66.2 C.Y.	5078 Lb.
NE ABUTMENT STEM	.6 C.Y.	42.5 C.Y.	2503 Lb.
NW ABUTMENT STEM	.6 C.Y.	57.0 C.Y.	3693 Lb.
NE BACKWALL STEM	1.0 C.Y.	10.3 C.Y.	468 Lb.
NW BACKWALL STEM	.7 C.Y.	9.0 C.Y.	420 Lb.

PROJECT ENGINEER E.A. Looker
 IN CHARGE OF C.C. Hall Jr.
 DESIGNED BY T. Mann
 DESIGN CHECKED BY A. Baker
 DETAILED BY R. Clements
 DETAIL CHECKED BY C.C. Hall Jr.

For design purposes the foundation pressure does not exceed 2 1/2 tons per square foot

- △ DIMENSIONS CORRECTED
- △ AS BUILT PEDestal GRADES NOTED
- △ SHARP CONCRETE CORNER DELETED

BRIDGE NO. 4
 INTERSTATE ROUTE 508
 Over
 ROUTE 206
 NORTH ABUTMENT EASTBOUND
 DRAWING NO. 16 OF 30

REFERENCE DRAWING
NOT TO SCALE

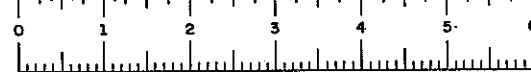

FED. RD. REG. NO.	STATE	FEDERAL AID PROJECT NO.	SHEET NO.	TOTAL SHEETS
1	NEW YORK		31/31	3/3

INTERSTATE ROUTE 508
APTON - BAINBRIDGE
CENHANGO COUNTY

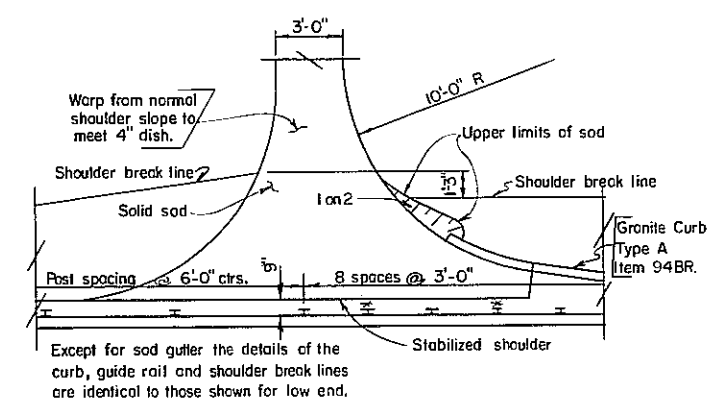
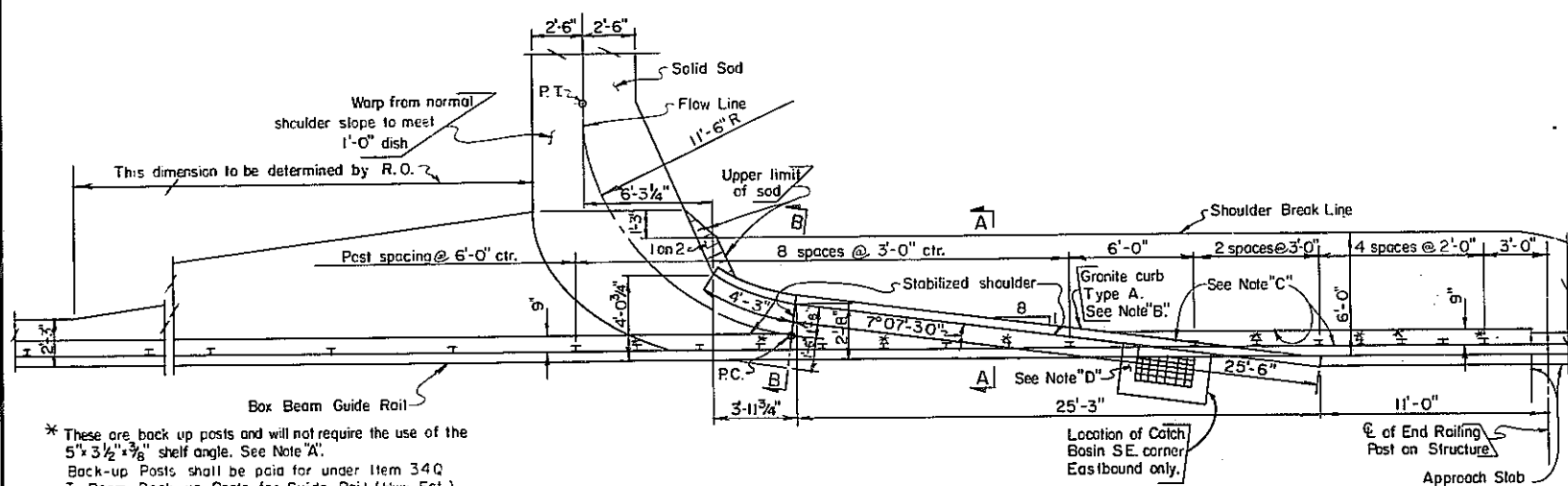

HIGH END
Northeast corner Eastbound (Shown)
Northwest corner Westbound (Similar)
Scale 1/4" = 1'-0"

* These are back up posts and will not require the use of the 5 1/2 x 3/8" shelf angle. See Note 'A'.
Back-up Posts shall be paid for under Item 340
I-Beam Back-up Posts for Guide Rail (Hwy. Est.)

LOW END
Southwest corner Westbound (Shown)
Southeast corner Eastbound (Similar)
Scale 1/4" = 1'-0"

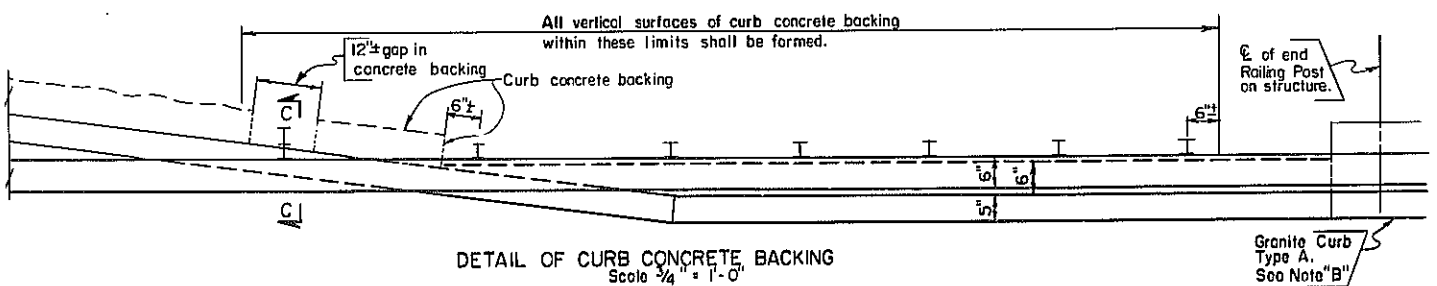
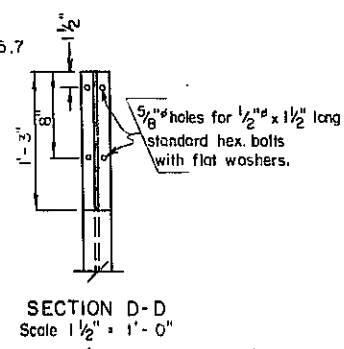
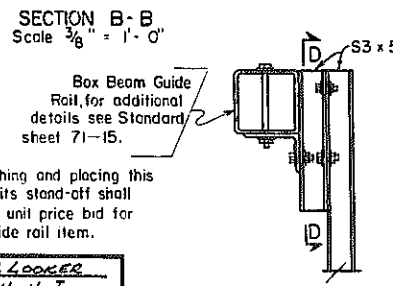
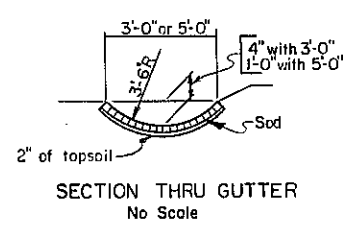
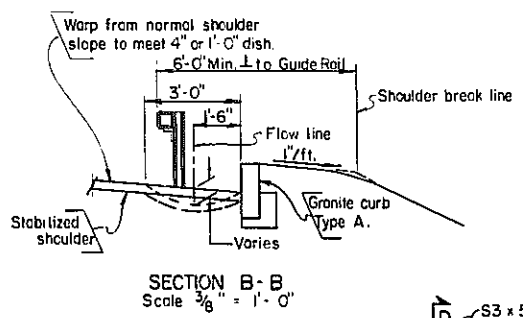
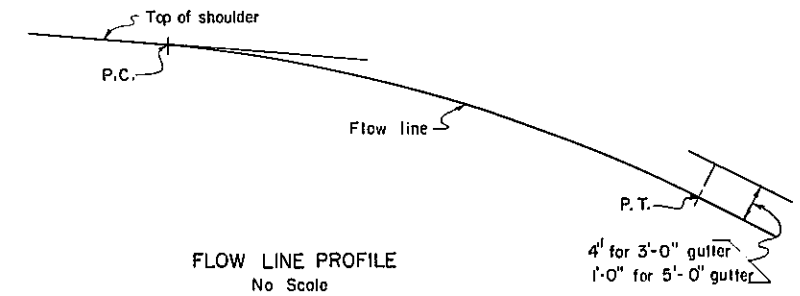
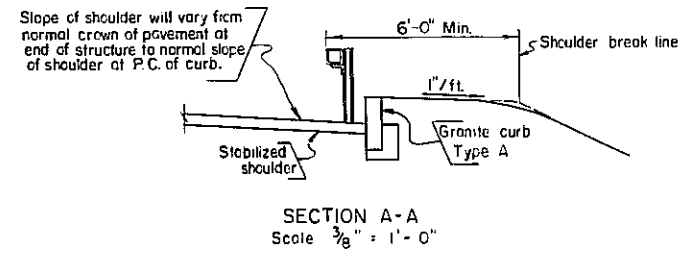

The cost of furnishing and placing this special post with its stand-off shall be included in the unit price bid for the box beam guide rail item.

PROJECT ENGINEER F.A. LOOPER
IN CHARGE OF C.C. HOLL, JR.
DESIGNED BY _____
DESIGN CHECKED BY _____
DETAILED BY William Burgess
DETAIL CHECKED BY C.C. HOLL, JR.

- NOTES**
- Back-up posts shall be omitted on the SW corner Westbound, and N.E. corner Eastbound.
 - For details of Granite Curb, Type A, see Common Details Drawing No. 3.
 - Pave this area with the same material as in stabilized shoulder. Payment will be made under the stabilized shoulder item.
 - For details of grating see Highway Plans.

~~SOD GUTTER DELETED~~

BRIDGE NO. 4
INTERSTATE ROUTE 508
over
ROUTE 206

DRAINAGE AND GUTTER DETAILS

DRAWING NO. 25 OF 90

REFERENCE DRAWING
NOT TO SCALE



FED. RD. PROJ. NO.	STATE	FEDERAL AID PROJECT NO.	SHEET NO.	TOTAL SHEETS
1	NEW YORK		312R	316

INTERSTATE ROUTE 508
APTON - BARDON BRIDGE
CHENANGO COUNTY

* These are backup posts and will not require the use of the 5" x 3 1/2" x 3/8" shelf angles.
Back-up Posts shall be paid for under Item 340 I-Beam Back-up Posts for Guide Rail (Hwy. Est.)

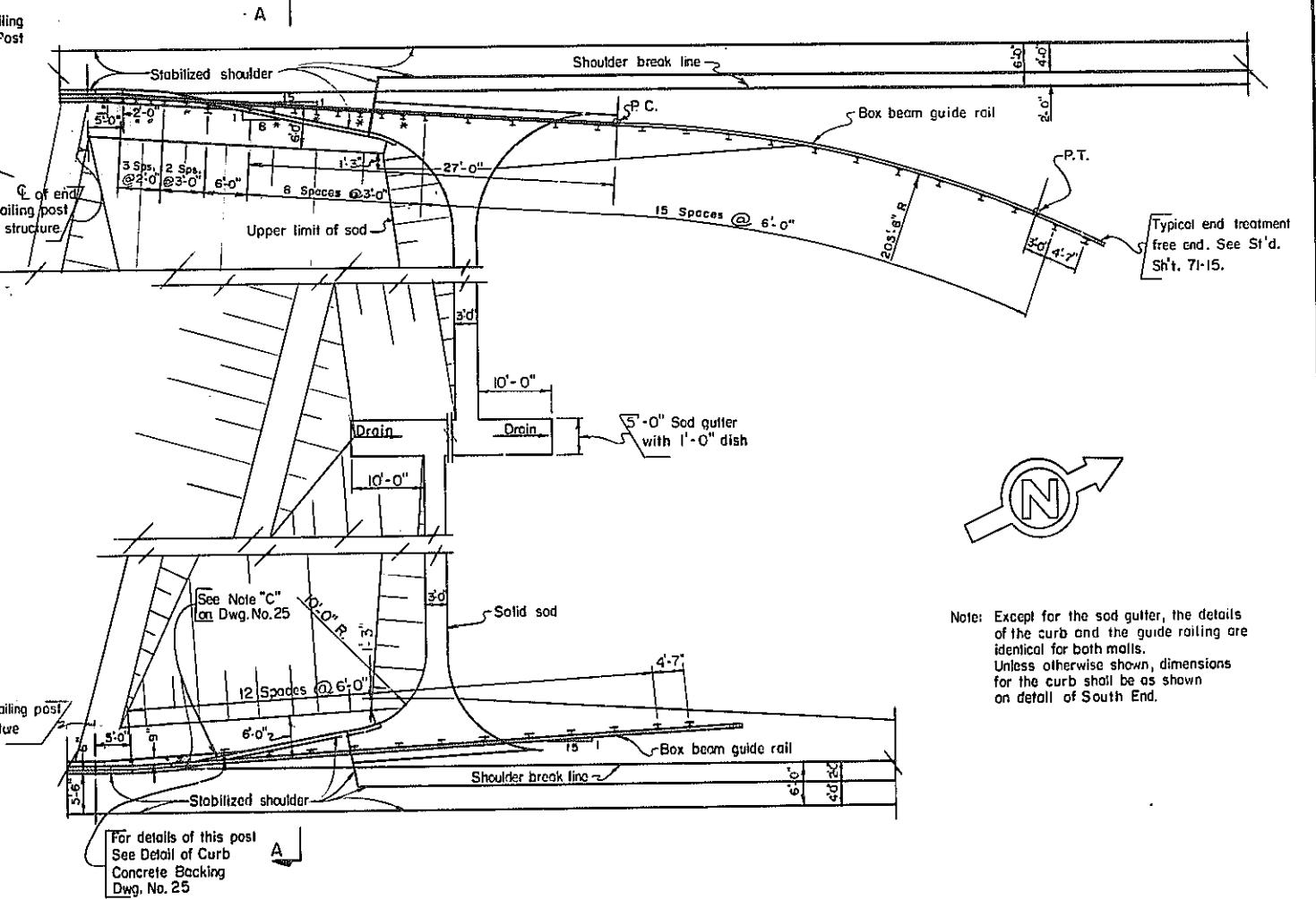
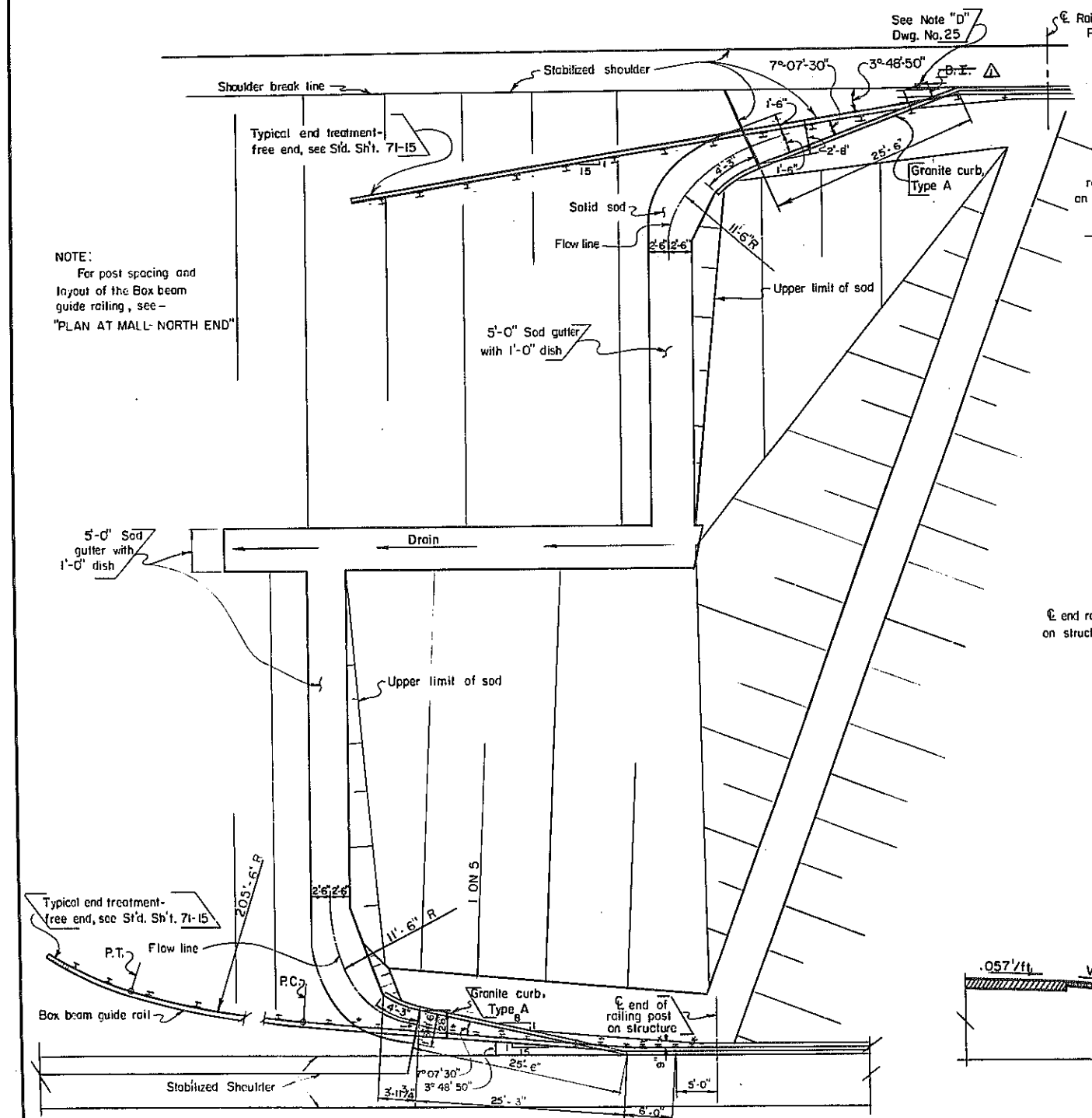

NOTE:
For post spacing and layout of the Box beam guide railing, see - "PLAN AT MALL - NORTH END"

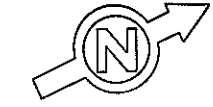

Note: Except for the sod gutter, the details of the curb and the guide railing are identical for both malls. Unless otherwise shown, dimensions for the curb shall be as shown on detail of South End.

PLAN AT MALL - NORTH END
Scale 3/32" = 1'-0"

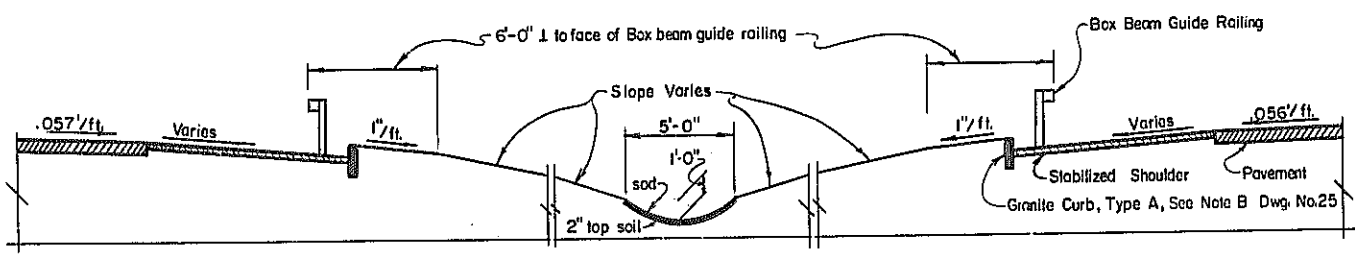
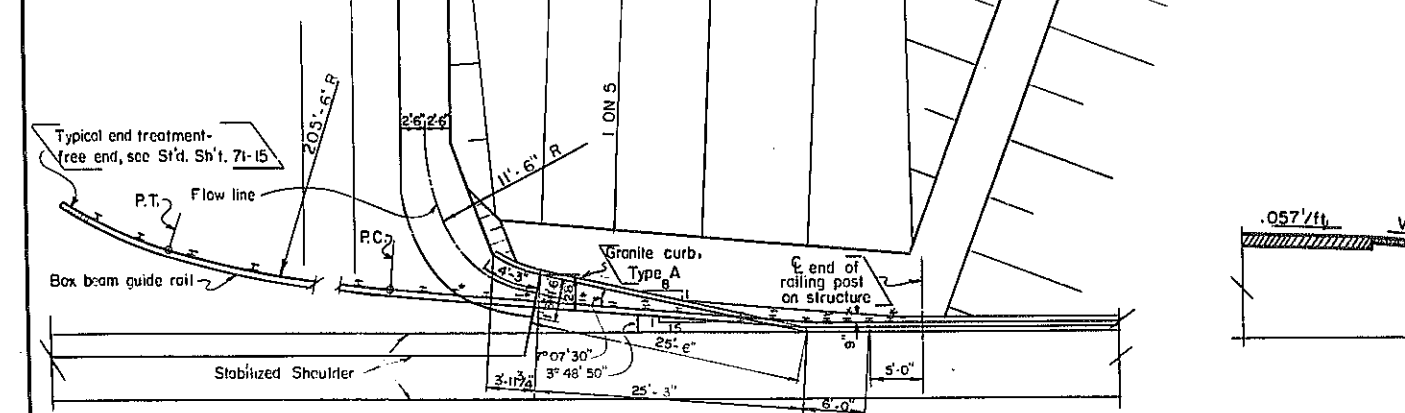

SECTION A-A
Scale 1/4" = 1'-0"

PLAN AT MALL - SOUTH END
Scale 1/8" = 1'-0"

PROJECT ENGINEER F.A. Looker
IN CHARGE OF B.C. Hall, Jr.
DESIGNED BY _____
DESIGN CHECKED BY _____
DETAILED BY Patricia A. Burgess
DETAIL CHECKED BY B.C. Hall, Jr.

~~D.I. Deleted~~
BRIDGE NO. 4
INTERSTATE ROUTE 508
over
ROUTE 206
DRAINAGE AND GUTTER DETAILS
DRAWING NO. 26 OF 30

**REFERENCE DRAWING
NOT TO SCALE**

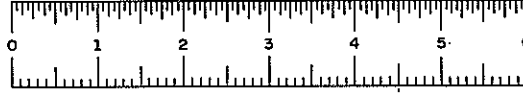

FED. RD. REG. NO.	STATE	FEDERAL AID PROJECT NO.	SHEET NO.	TOTAL SHEETS
1	NEW YORK		313R	316

INTERSTATE ROUTE 508
AFTON - BATHURIDGE
CHEMANGO COUNTY

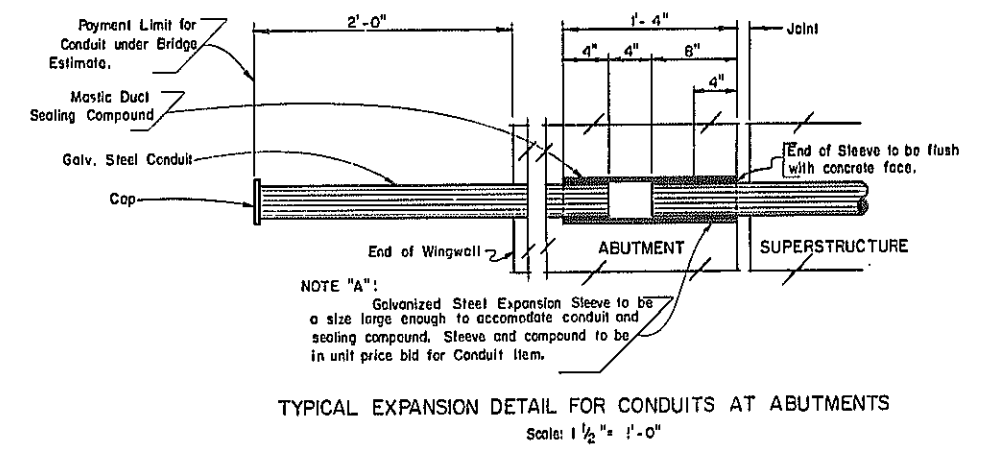
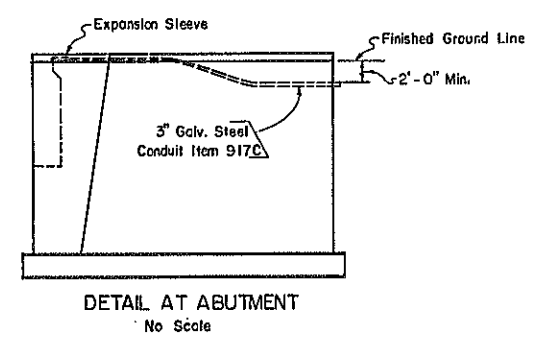
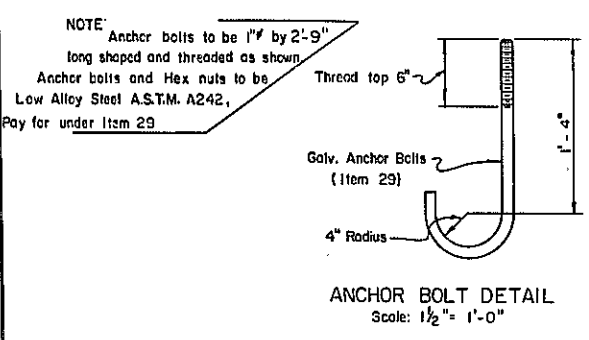
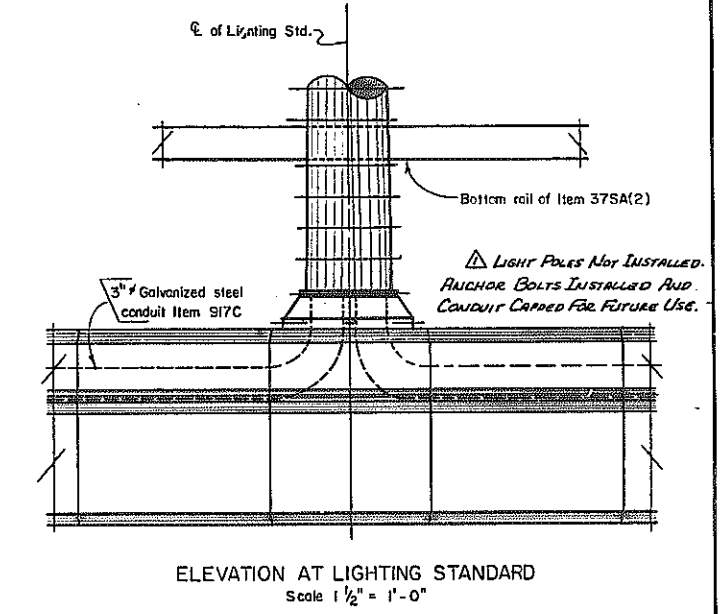
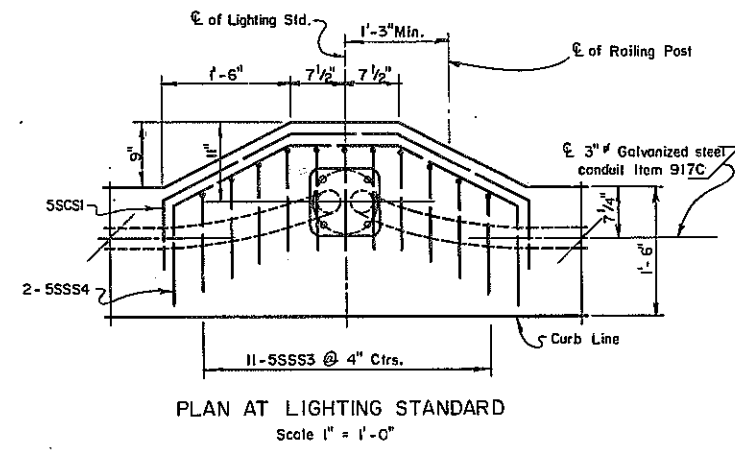
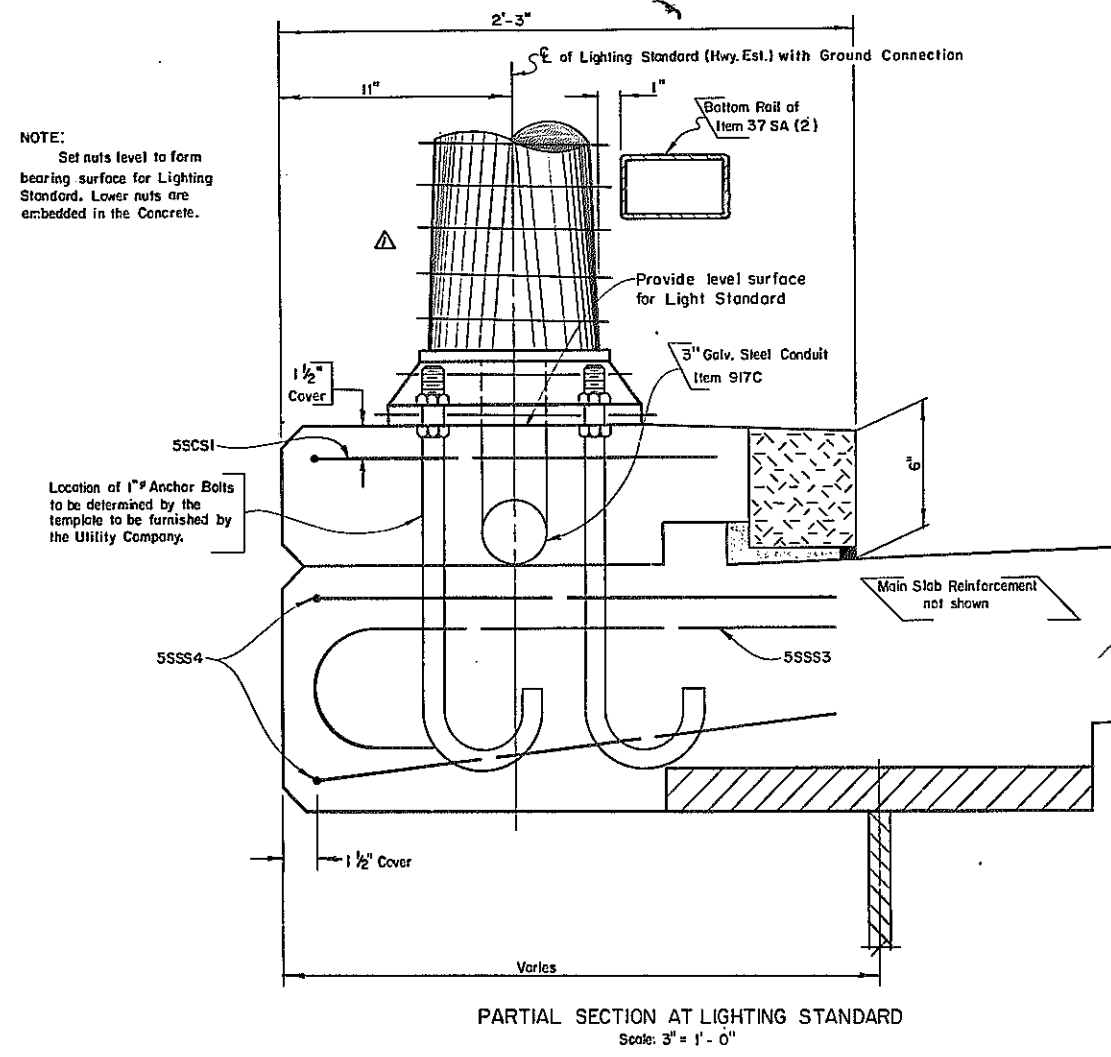

PROJECT ENGINEER F.P. LOOKER
IN CHARGE OF C.C. HALL JR.
DESIGNED BY _____
DESIGN CHECKED BY _____
DETAILED BY Patricia A. Burgess
DETAIL CHECKED BY C.C. Hall Jr.

△ LIGHT POLES DELETED

BRIDGE NO. 4
INTERSTATE ROUTE 508
over
ROUTE 206

LIGHTING DETAILS
DRAWING NO. 27 OF 30

REFERENCE DRAWING
NOT TO SCALE